



**HEAD OFFICE**  
**JONES TOWERS**

Velachery – Tambaram Main Road,  
Kamakotti Nagar, Pallikaranai,  
Chennai – 600100

**SITE ADDRESS**  
**JONES VISTA**

Padmavathy Nagar Main Road,  
Via Padmavathy Nagar 2nd St.  
Velachery, Chennai – 600042

 [www.jonesfoundations.com](http://www.jonesfoundations.com)

 +91 87 5005 6004



RERA: TN/29/BUILDING/0162/2025 ([www.rera.tn.gov.in](http://www.rera.tn.gov.in))

This brochure is purely conceptual and does not constitute a legal document. Visual representations are not to be taken as representations of fact, and do not form part of an offer or contract. The management of Jones Foundations Pvt Ltd reserve the right to add, delete or alter any specifications mentioned here.

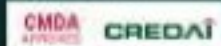

JONES  
**Vista**  
LIFESTYLE REDEFINED

3 BHK | 36 Units  
1319 to 1538 Sq.ft  
A Block - Stilt + 4 Floors  
B Block - Stilt + 5 Floors



Rera: TN/29/Building/0162/2025 ([www.rera.tn.gov.in](http://www.rera.tn.gov.in))



Your Journey to **Happy Living Begins Here!**

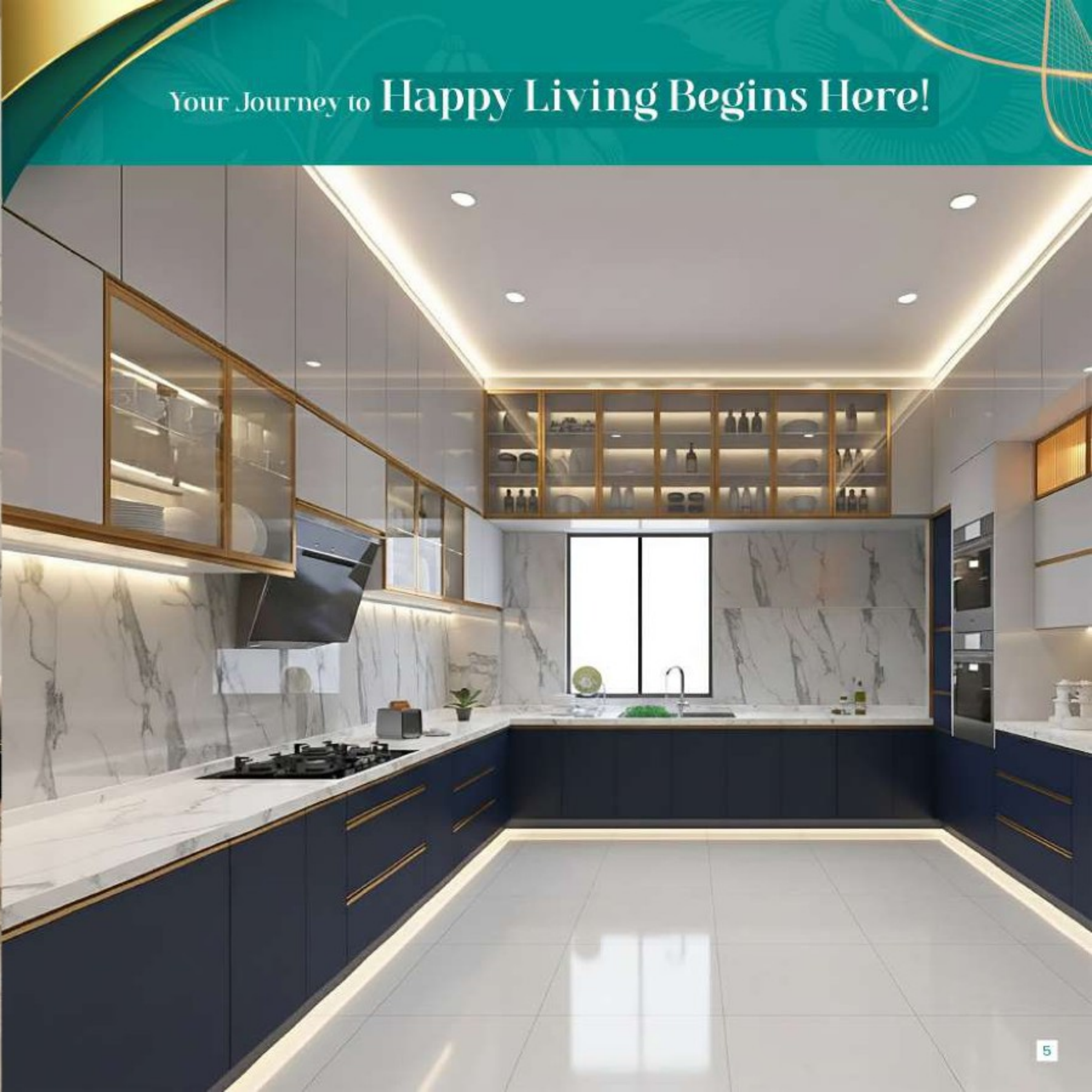

Graceful Spaces, Effortless Living

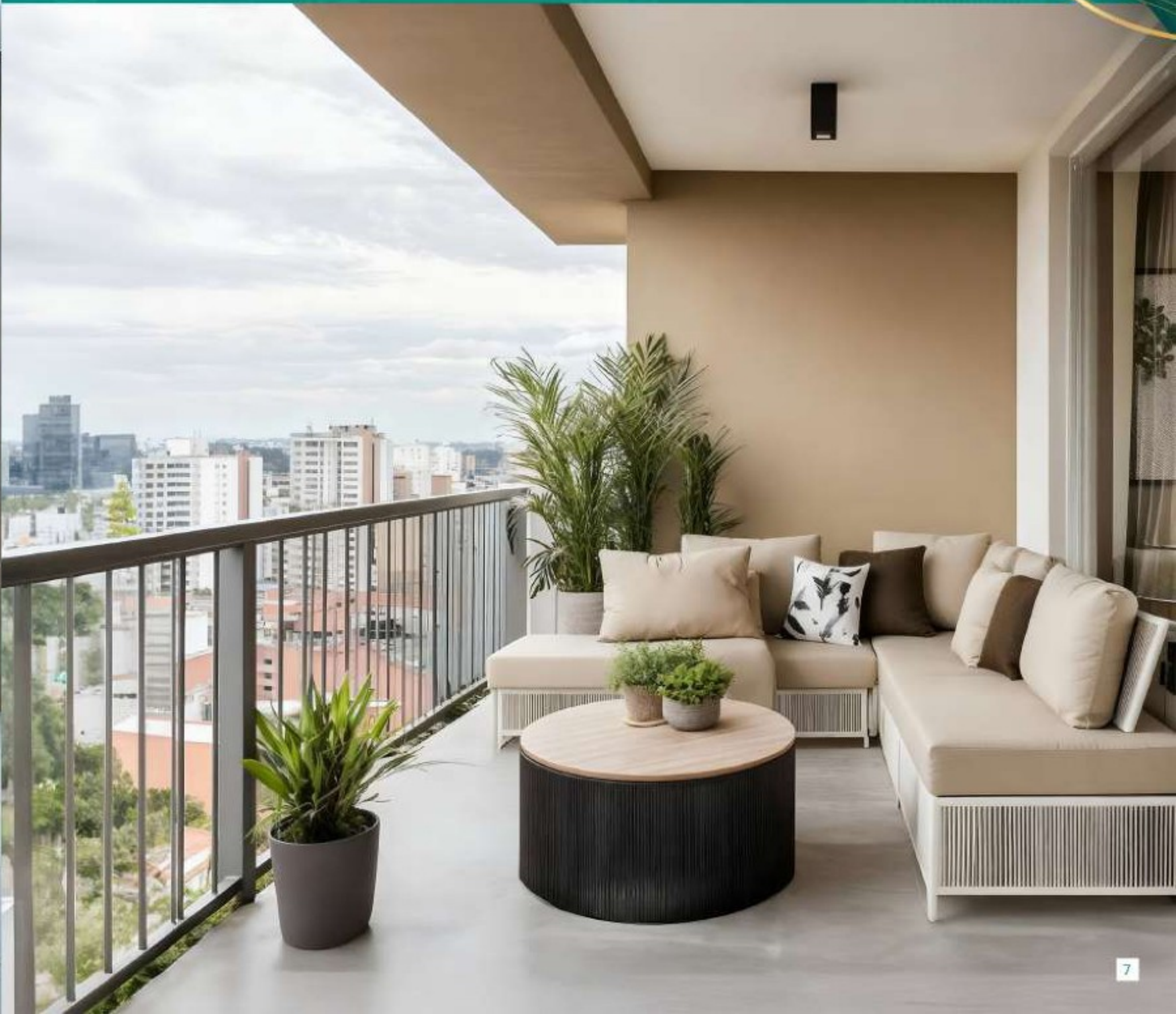

# TYPE - 1

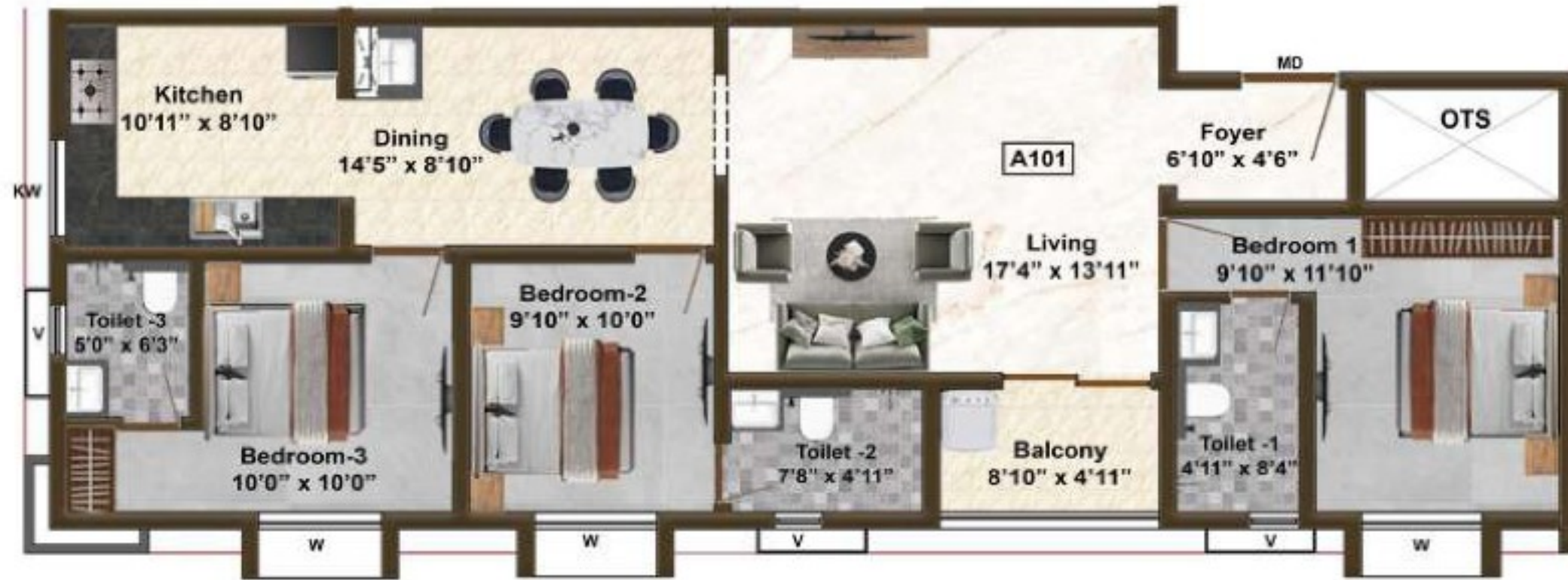

Flat No.	Saleable Area
A101, A201, A301, A401	1325.00 Sq.ft

**Key Plan**

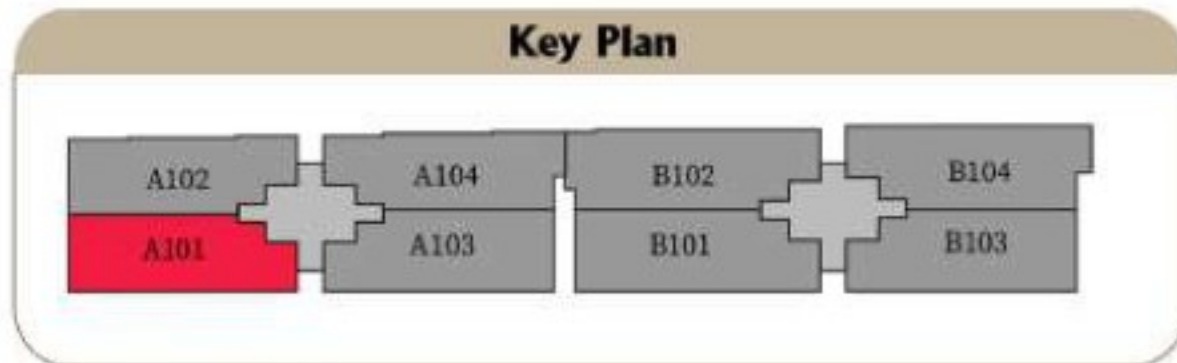

# TYPE - 2

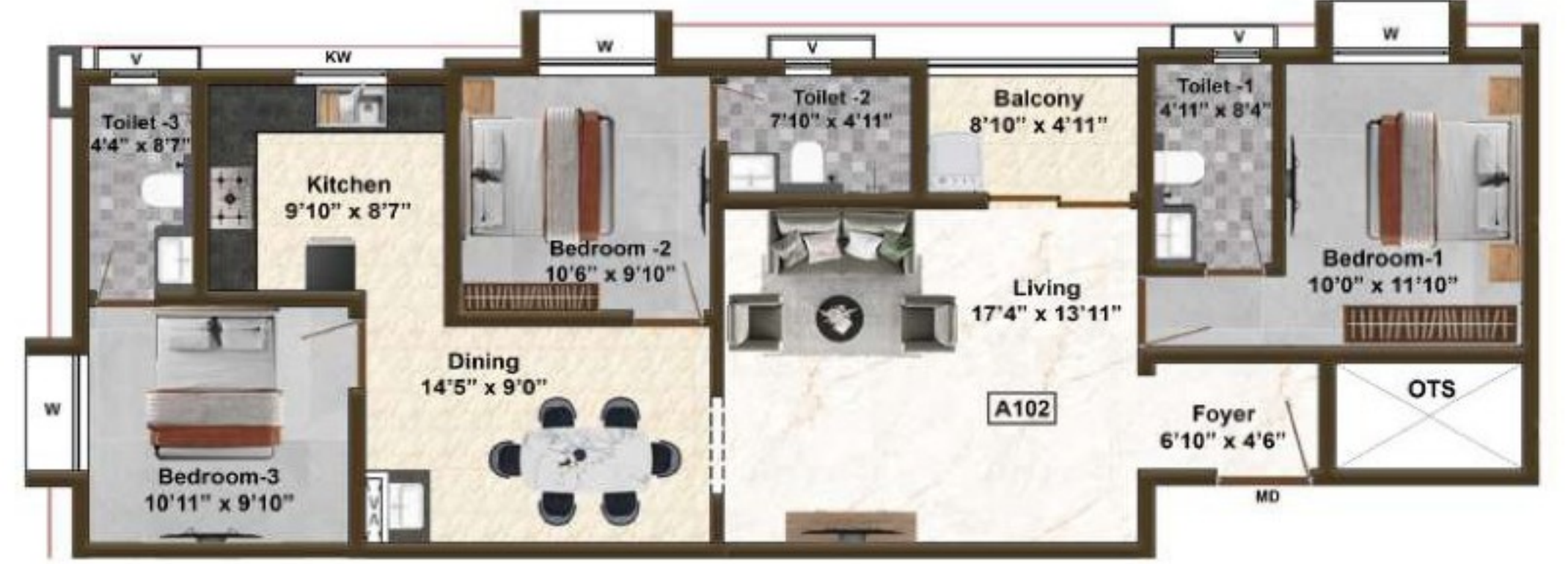

Flat No.	Saleable Area
A102, A202, A302, A402	1319.00 Sq.ft

**Key Plan**

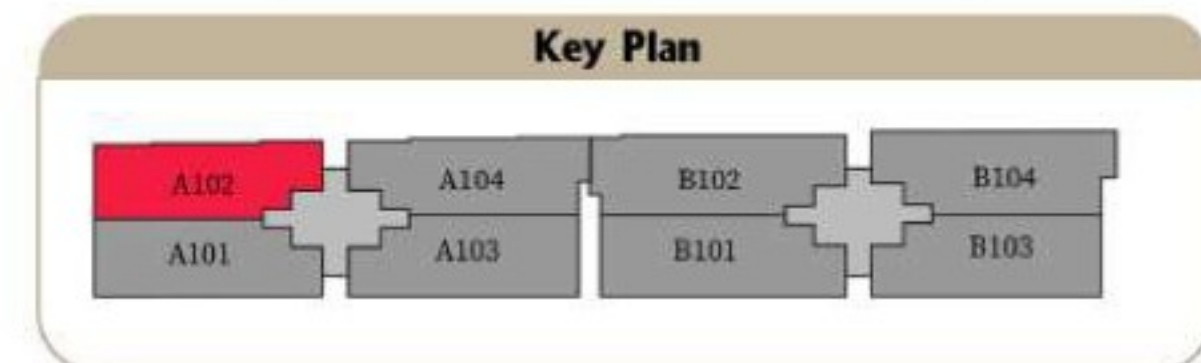

Prime Location,  
Premium Lifestyle!

JONES  
**Vista**  
LIFESTYLE REDEFINED



## Amenities



Centralized AC Gym



CCTV Surveillance



24/7 Security

# Specification

## Structure

RCC Framed Structure

## Masonry

AAC Block Work - Aerocon / Equivalent

## Plastering

Cement Mortar Plastering

## Joineries

**Windows:** UPVC frames with Sliding glazed shutters and MS grills fixed on the inner side of frame.

**French Doors:** UPVC frames with Sliding glazed shutters

**Ventilators:** UPVC frames with fixed louvers

**Main Door:** Teak Wood Door frame and Architrave with shutter of Veneer Finish

**Bedroom Door:** Teak Wood Door frame and Architrave with shutter of Veneer Finish

**Toilet Door:** Teak Wood Door frame and Architrave with shutter of Veneer/ACP Finish

## Painting

**Internal Walls & Ceiling:** Cement Based Putty with Emulsion Finish.

**External Walls:** Texture Finish with Weather Proof paint

## Tiles

**Flooring:** Vitrified Tiles of Size 1200 x 600 mm

**Toilet Flooring:** Anti Skid Vitrified Tiles of Size 600 x 600 mm

**Balcony:** Anti Skid Ceramic Tiles of Size 600 x 600 mm

**Toilet Walls:** Glazed Tiles of Size 1200 x 600 mm

**Kitchen Walls:** Glazed Tiles of Size 600 x 600 mm

**Car Parking:** Vitrified Parking Tiles of Size 300 x 300 mm

**Drive Way:** Inter locking Paver Blocks

## Handrail

**Balcony Handrail:** M.S Handrail with Enamel Paint Finish

**Staircase Handrail:** M.S Handrail with Enamel Paint Finish

## Electrical

**Power Supply:** 3 Phase power supply connection

**Safety Device:** MCB & RCCB [Residual Current Circuit Breaker]

**Switches & Sockets:** Modular Switches & Sockets of Crabtree / Equivalent.

**Wires:** Fire Retardant Low Smoke [FRLS] Copper Wire Havells / Equivalent

**TV Point:** Living & All Bedrooms

**Data Point:** Living & Master Bedroom

**Split A/C Point:** Living & All Bedrooms

**Exhaust Fan Point:** Kitchen & All Toilets

**Geyser Point:** All Toilets

**RO Point:** Kitchen

**Chimney Point:** Kitchen

**DG Backup:** 1000 Watts for each Flat

## Plumbing

**Internal Water Line:** CPVC - Ashirvad / Equivalent

**External Water line:** UPVC - Ashirvad / Equivalent

**Soil / Waste lines:** PVC - Ashirvad / Equivalent

**Cp Fittings:** Jaquar / Equivalent

**Sanitary Fittings:** Jaquar / Equivalent

## Amenities

24/7 Security / CCTV Surveillance

Rainwater Harvesting System

Centralized UG Sump for Water Storage

Centralized AC Gym

Roof Top - Open Party Hall / Roof Top Garden

## Common Features

**Lift:** Automatic Lift with SS Finish

**DG Backup:** 100% Power Backup for common area

**Lift Lobby:** 600 x 600 mm Tiles

**Staircase:** Granite Flooring



SCAN FOR SITE LOCATION



# Location Map

