

श्री Keshav Complex

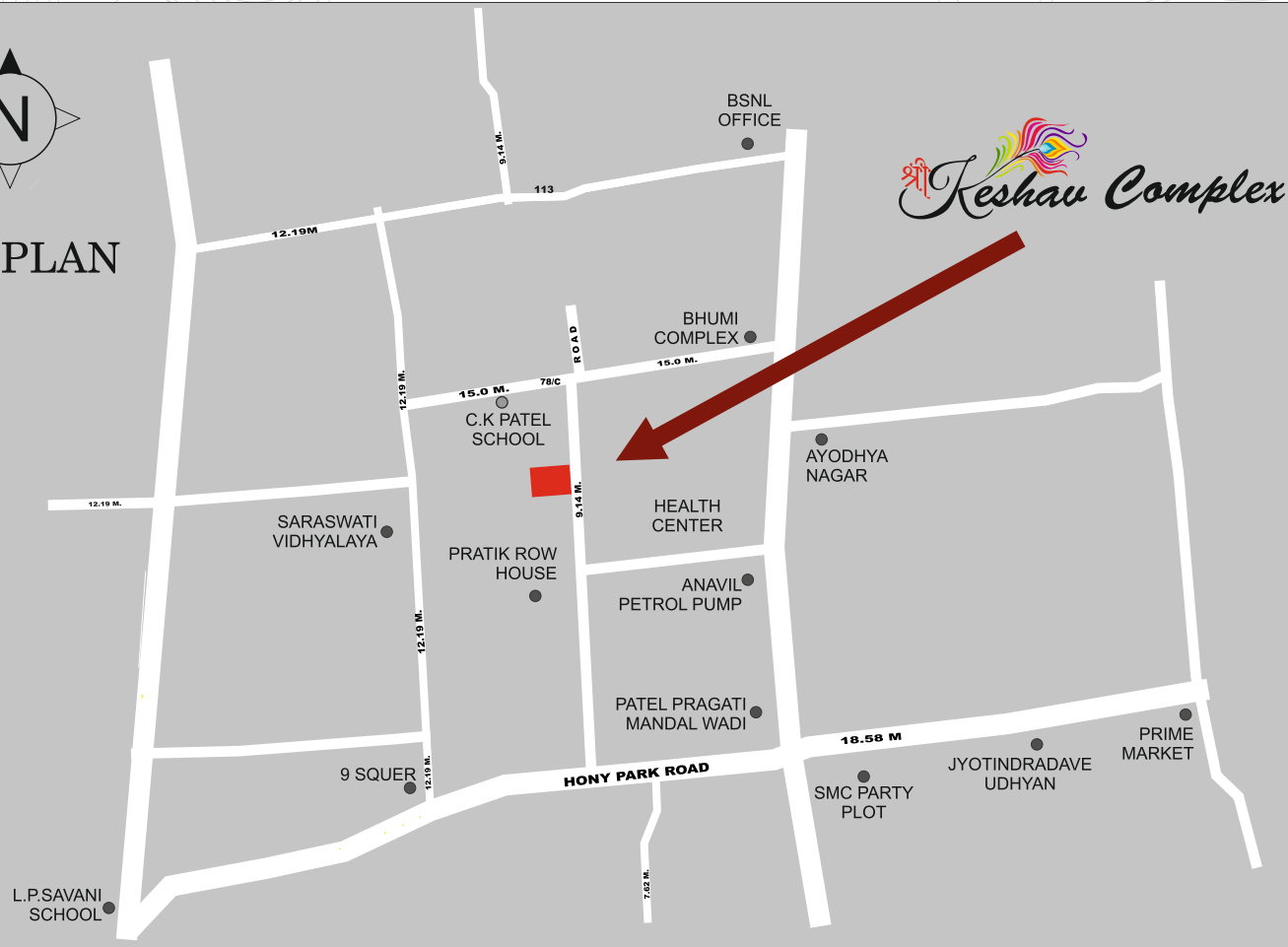

- **Note**
- Developers reserves right of any changes in Planning Design, Elevation.
- This brochure is only for general information it is not any Legal Document/ Agreement.
- Registration fees, Electrical Meter, Gas Bill, GST current and in future will be bore by members.

PROJECT BY

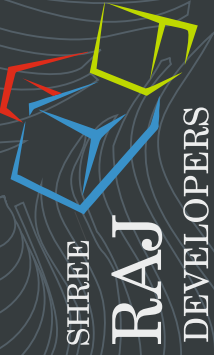

<u>INQUIRY AT</u>	<u>ARCHITECT</u>	<u>STRUCTURE DESIGNER</u>	<u>LEGAL ADVISOR</u>
96876 12368 99094 09668 98251 51268	JIGNESH C. PATEL	HIREN G. DESAI	DIPAK J. CHALIYAWALA

TP 13, FP 54, KESHAV COMPLEX CO-OP HOUSING SOCIETY, NEAR PRATIK ROW HOUSE, HONEY PARK ROAD, ADAJAN, SURAT.

श्री Keshav Complex





The Project

A unique project is a refelaction of the most contemporary and comforting lifestyle situated in the heart of city and surrounded by all the most common day to day necessities of life. This heaven has been equipped with all the desired and deserved amenities. This perfect peaceful home allow you to add a touch of elegance and style to your life, make your presence certain at the Shree Keshav Complex. A wall ventilated design gives a feeling of spaciousness, which is an outcome of the latest concept in morden living.

SPECIFICATIONS

- **STRUCTURE**
 - Earthquake resistant RCC framed structure.
- **WALLS**
 - INTERIOR : Smooth Plaster with white putty finishing.
 - EXTERIOR : Double coated plaster with attractive color scheme.
- **FLOORING & TILING**
 - 24" x 24" Vitrified tiles in all rooms.
 - fully glazed tiles in toilet and wash upto lintel level.
 - Granite flooring in stair trade.
- **CHILDREN PLAY AREA**
- **KITCHEN**
 - Granite kitchen platform with S.S. sink and glazed tiles upto lintel level.
 - Marbel rack with glazed tiles in store.
- **DOOR-WINDOWS**
 - Decorated laminated Main door with standard safety lock and fitting.
 - Internal water proof laminated flush doors.
 - Powder coated aluminum section windows with reflective glass.
 - Granite marble window seal and toilet door frame.
- **PLUMBING**
 - Concealed plumbing with C.P. Fitting
 - S.M.C water supply with UG & OH water tank.
 - Borewell with pump in each wing.
- **ELECTRIFICATION**
 - Sufficent point in concealed wiring of ISI company.
 - Modular switches & sockets.
 - A.C. point in bedroom.
 - TV points in living room and bedroom.
- **SAFETY FEATURES**
 - C.C.T.V surveillance system on ground floor.
 - Fire and safety equipments provided as per norms.
- **LIFT**
 - Standard ISO quality elevators.
- **TITTLE**
 - Loanable title clear project.



NIGHT FRONT VIEW



SIDE VIEW

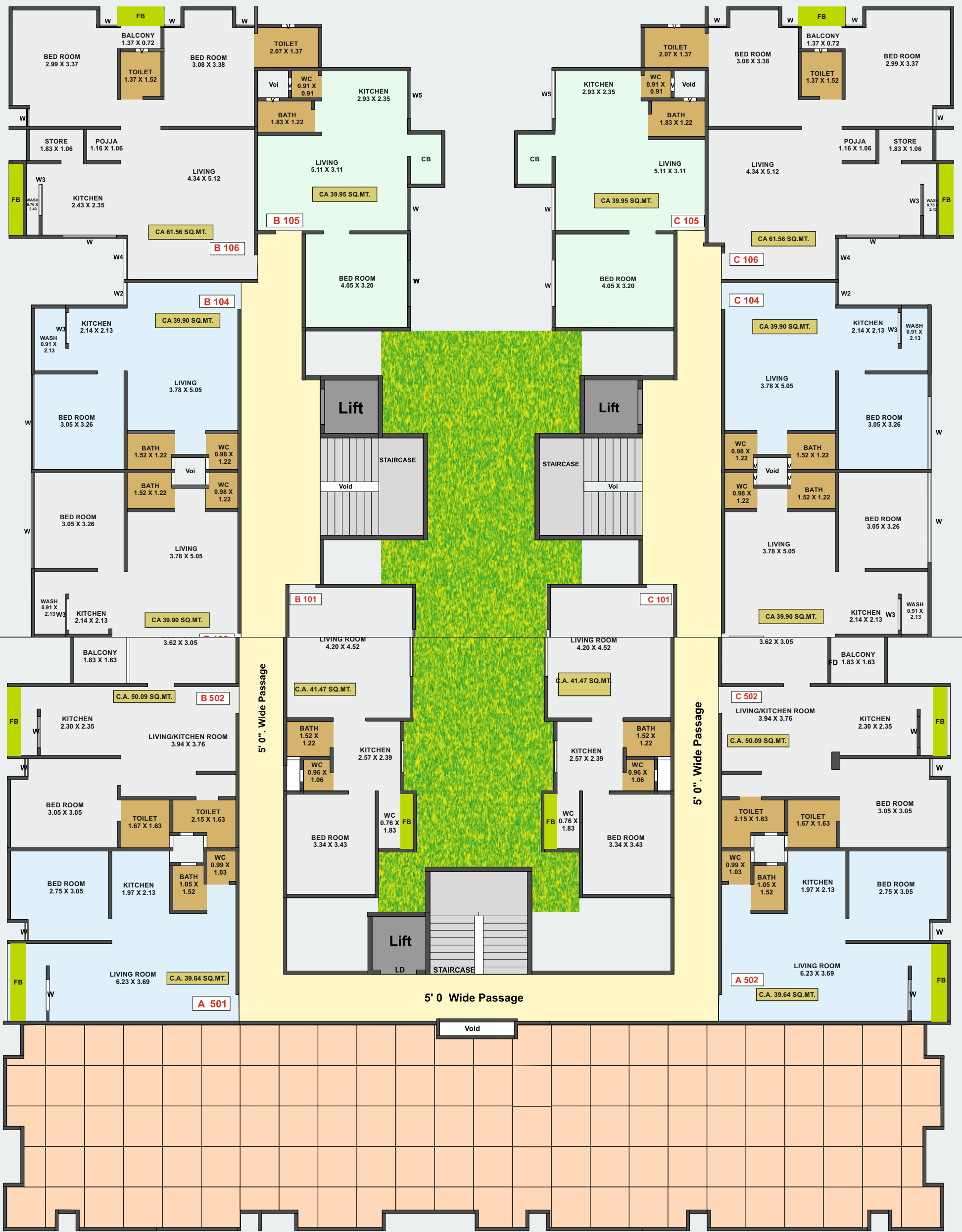

5th FLOOR PLAN

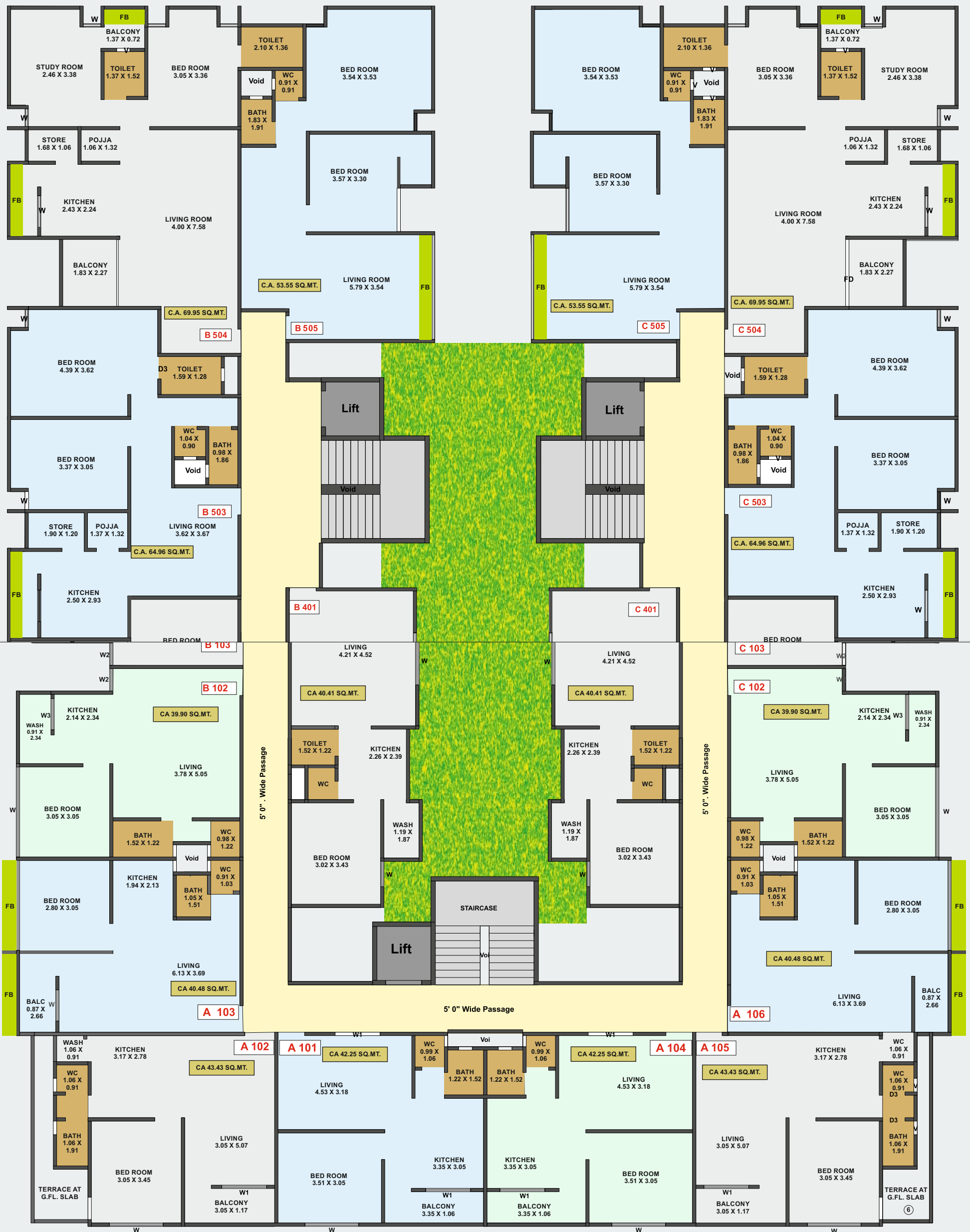

1st, 2nd & 3rd FLOOR PLAN

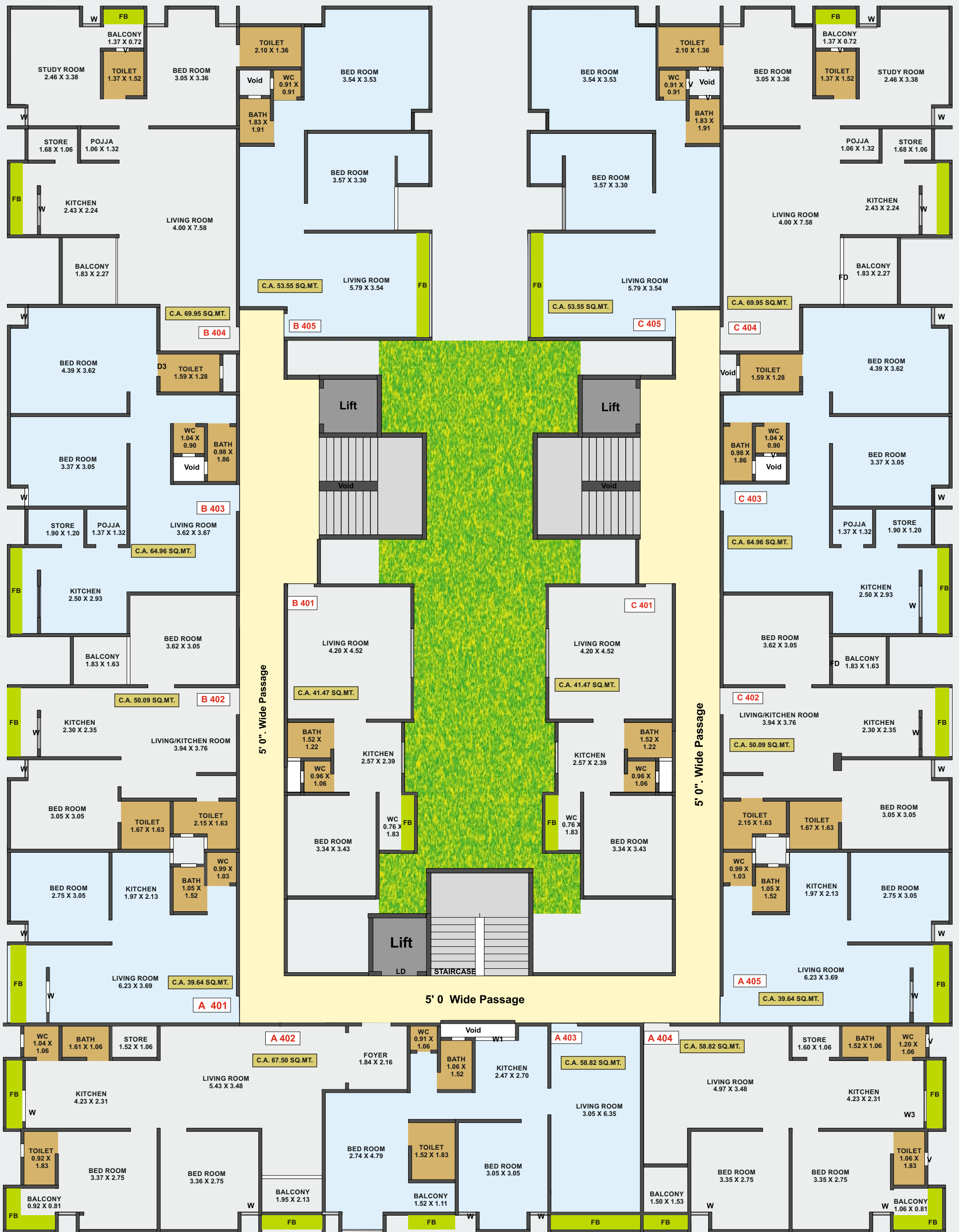

4th FLOOR PLAN