



**JEWEL CITY**

UMROLI, PANVEL

# SPECIFICATIONS



## FLOORING

- Vitrified flooring in all rooms & Lobby
- Anti-skid flooring in toilet, bath & balcony



## KITCHEN

- Granite kitchen platform with S.S. sink
- Designer glazed tiles up to beam height
- Water purifier point & washing machine point



## DOORS & WINDOWS

- Decorative laminated main & internal doors with wooden frame
- F.R.P. doors for bathroom & toilet
- Powder Coated aluminium sliding window



## ELECTRIFICATION

- Concealed copper wiring with MCBs
- Adequate electrical points in all rooms
- ISI modular switches of premium brand
- Power backup for all common lobby lights



## WALL AND PAINTS

- Emulsion paint for internal walls
- Acrylic paints for external walls



## BATH & W.C.

- Designer glazed tiles up to beam level
- Branded sanitary wares with premium quality C.P. fittings
- Exhaust Fan point & Geyser point



## WATER TANK

- Underground and overhead water tank with adequate storage capacity



## TERRACE

- Waterproofing treatment with brickbat underlay.



A 3D architectural rendering of a modern multi-story apartment building at night. The building features a central vertical shaft with a series of windows and balconies. The balconies are illuminated from within, and the windows are also lit up. The ground floor is a commercial strip with various retail stores, including 'Trolees', 'clothes', 'sport', 'Lee Cooper', 'Nike Factory Store', 'clothes', 'PUMA', 'Wrangler', and 'Indor Lifestyle'. People are walking on the sidewalk in front of the building, and a car is parked on the left. The sky is dark blue, suggesting dusk or night.

Indor Lifestyle Trolees clothes sport Lee Cooper Nike Factory Store clothes PUMA Wrangler Indor Lifestyle



# LAYOUT PLAN



1 BHK FLAT ( 3D VIEW )

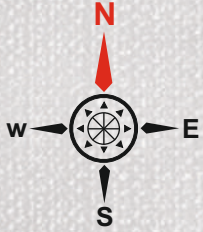



# BUILDING - 2



## PROJECT FEATURES

- G+7 Storey Residential cum Commercial Project. (CC obtained only for G+3 Storey)
- Planned and approved by NAINA (CIDCO)
- Exclusive Shops, 1BHK, 1RK, 2BHK apartments
- Earthquake Resistant R.C.C. Design
- Lift of reputed brand
- Loan Available from all leading banks
- Luxurious Club House with garden



## LOCATION FEATURES

- Near Sion-Panvel Highway & Mumbai-Pune Expressway
- 20 minutes drive from proposed International Airport
- 15 minutes drive from S.T. Depot & Panvel Railway Station
- 30 minutes drive to proposed Sewri / Nhava Sheva Sea Link
- Orion Mall & PVR Cinemas
- Reputed school & colleges  
DAV Public School & Pillai College of Engineering,  
Changu Kana Thakur Institute of Management Studies,  
Dr. Pillai Global Academy, Mahatma International School,  
St. Josephs High School, New Horizon Public School.
- Project surrounded by forest and green fields but at the same tie close to the city.

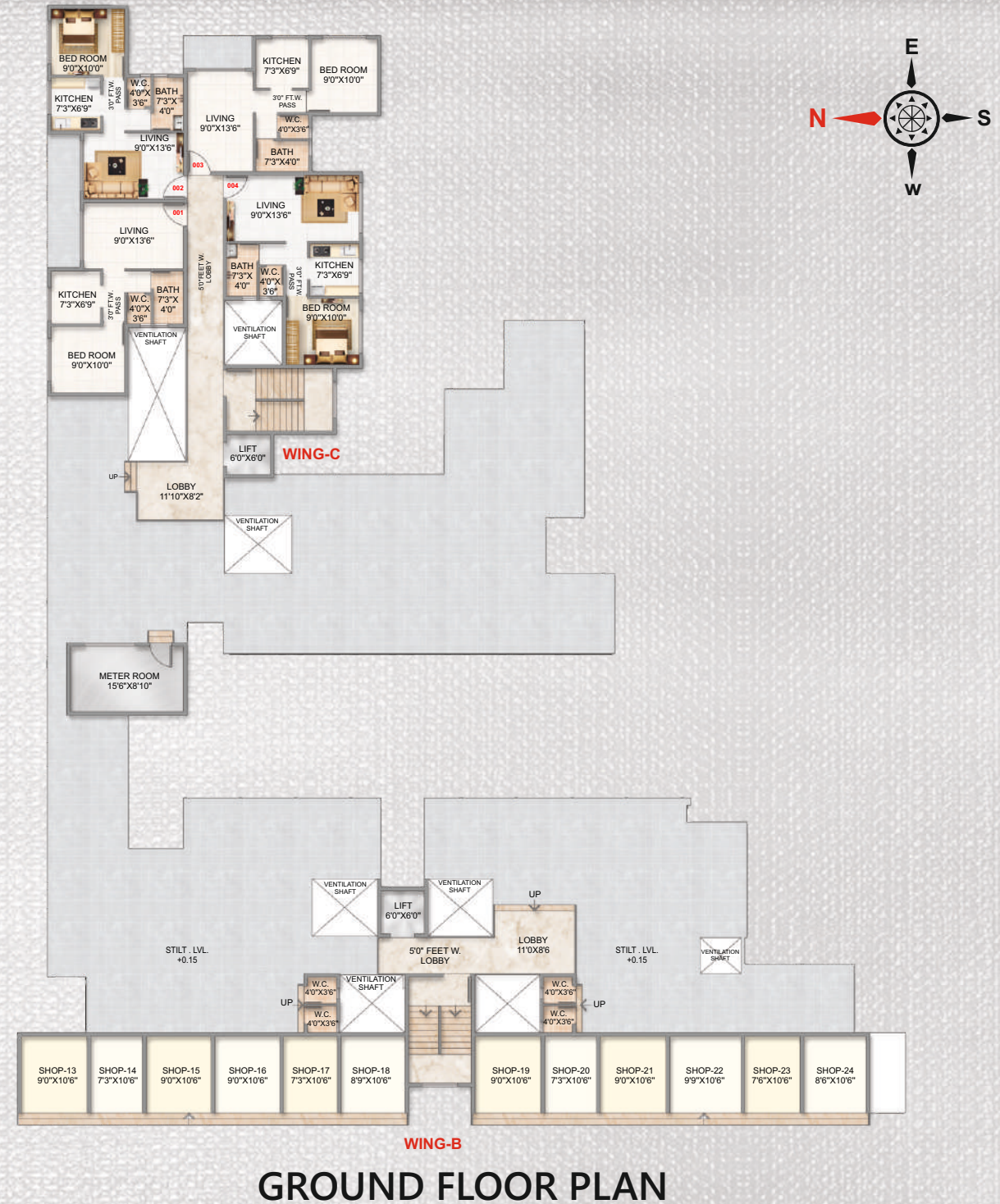

**GROUND FLOOR PLAN**





Project by

**M/s. JEWEL DEVELOPERS**

In Joint Venture With:

**M/s. RAM KRISHNA HARI FARMS PVT LTD.**

Site Address: S.No. 62/3/2, 62/6, 63/4/B/2, 63/7, 63/8, 63/9/B, 63/10, 63/11,  
63/14, 63/16, Umroli Village, Taluka Panvel, District Raigad, Maharashtra

Architect: Swapnil Kalyankar Architects

R.C.C. Consultant: Prapti Associate



**MAHARERA**  
REGISTERED PROJECT  
<https://maharera.mahaonline.gov.in>

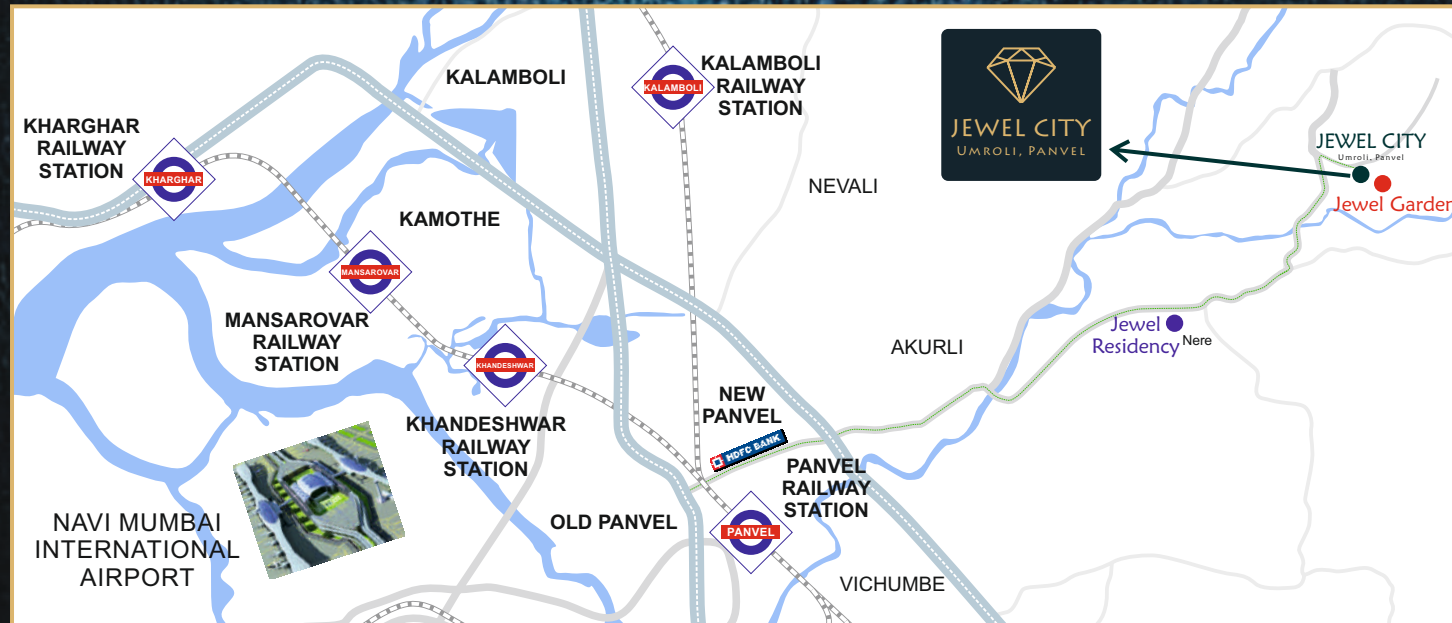

**For Booking Contact :**

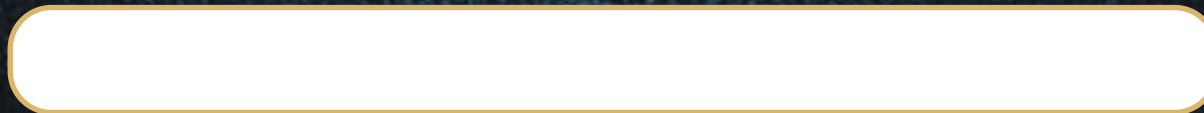

**Disclaimer :**

While every care has been taken in the preparation of this brochure the developers/promoters reserve their rights to make alterations, amendments including additional construction of the building/property as may be necessitated/permitted from time to time. The developers/promoters reserve their right to add/delete/modify any facility/amenities in the building / flat at the time of execution of the agreement to the sale of the flats. Images used in the advert are for representation purposes only. The elevation, colour, number of floors of the proposed building is an artist's impression of the same and the final product may differ on eventual execution. Moreover, the background and other elements used in the image are imaginary and for the sole purpose of enhancing the portrayal of the proposed building. The communication is purely conceptual and not a legal offering. It is made only for promotional purposes. The project is sanctioned till 3 storeys as per Commence Certificate (CC) issued by NAINA-CIDCO Office, bearing Certificate No. CIDCO/NAINA/Panvel/Umroli/CC/2023/0355 Dated 28 April 2023. CC for remaining storeys is under