

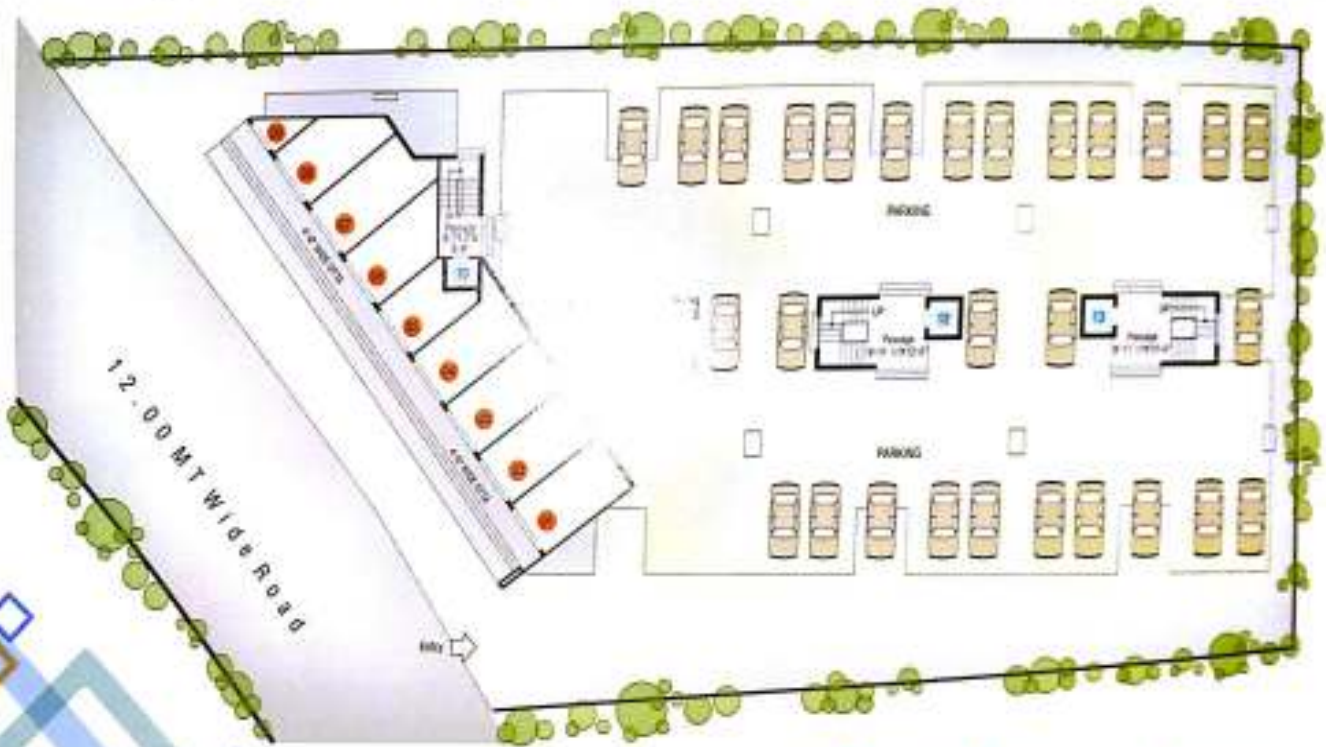

# Ground Floor Plan with Shops



- |                |                |                   |
|----------------|----------------|-------------------|
| ■ 10-2013-0*   | ■ 10-2017-4 U* | ■ LRT 4-2 U 19 0* |
| ■ 10-2019-0*   | ■ 10-2019-0*   | ■ LRT 5-000-0*    |
| ■ 10-2019-0*   | ■ 10-2019-0*   | ■ LRT 5-000-0*    |
| ■ 10-2019-0*   | ■ 3-4 U 10-0*  | ■ LRT 5-000-0*    |
| ■ 10-2011-4 U* |                |                   |



Tower B C D  
Typical Floor Plan  
1 / 2 / 3 / 4 / 5 floor



Super Built-up  
1100 S.Q. F.T.







## Amenities

- 24 hrs. water supply
- Lift/liftbox for each unit.
- Paved parking & RCC internal road
- Water proofing treatment at terrace.
- 6 seater, standard quality elevators in each tower.
- Anti termite treatment in all tower.

## Specifications

- Earthquake resistance RCC frame structure as per structure design.
- Internal smooth plaster, white cement putty with distemper paint and External double coat plaster with water resistant paint.
- Elegant entrance door and internal flush door with laminated sheet with stone frame
- Fully glazed aluminum window.
- Vitrified tiles flooring in all rooms.
- Good quality granite platform with stainless steel sink and deck tiles up to fitted level.
- Designer tiles up to fitted level with standard quality C.P fittings in all toilet.
- Branded concealed ISI mark wiring, AC point in master bedroom, Geyser point in all toilet, RCCB in each apartment and good quality semi modular switches.
- Fully glazed overhead and under ground water tank in each tower.









# Shree Hari

SHOPS & 2 BHK FLATS

## Amenities

- 24 Hrs. water supply.
- Letterbox for each units.
- Paved parking & RCC internal road
- Water proofing treatment at terrace.
- 5 passenger, standard quality elevator in each tower.
- Anti termite treatment to all tower.

## Specifications

- Earthquake resistance RCC frame structure as per structure design.
- Internal smooth plaster, white cement putty with distemper paint and External double coat plaster with water resistant paint.
- Elegant entrance door and internal flush door with laminate sheet with stone frame
- Fully glazed aluminum window.
- Vitrified tiles flooring in all rooms.
- Good quality granite platform with stainless steel sink and dado tiles up to lintel level.
- Designer tiles up to lintel level with standard quality C.P. fittings in all toilet.
- Branded concealed ISI mark copper wiring, AC point in master bedroom, Geyser point in all toilet, RCCB in each apartment and good quality semi modular switches.
- Fully glazed overhead and under ground water tank in each tower.