



WELCOME TO THE LIMITED EDITION HIGH LIFE.



Where luxury meets nature.
Discover a harmonious blend of breathtaking views, impeccable design,
and exceptional living experiences.

Elevate Living: Unparalleled Amenities, Infinite Experiences.



Experience a lifestyle of unrivaled indulgence. Our exquisite project offers a curated collection of world-class amenities, meticulously designed to enrich your everyday life. Elevate your living with unparalleled comfort and opulence. From lush green spaces to serene poolsides, indulge in a lifestyle that seamlessly blends opulence with convenience, making every moment extraordinary.



Redefining Living, Elevating Expectations

"A symmetrical residential structure with wide glass panels,
minimalist design elements, and a well-lit, inviting main entrance."

Sky-high Elegance, Unmatched Views

Step onto your spacious terrace, offering panoramic views of
the city and a peaceful escape above it all.



Specifications

Exquisite Details, Unmatched Quality, Your Dream Home.

Crafting perfection in every detail, our project offers an exquisite fusion of aesthetics and functionality. From luxurious finishes to advanced technology, experience a harmonious blend of elegance and modern living, redefining your notion of a dream home.

FLOORING

MASTER BED ROOM/DRAWING & DINING AREA/OTHER BED ROOMS
600 mm X 600 mm Vitrified tiles flooring of well-known brands.

BALCONIES

600 mm X 600 mm Vitrified tiles with drainage system and exterior emulsion paints.



BACKUP POWER

Silent DG set of reputed brands for power backup in all common areas & flats.

TOILETS

300 mm X 300 mm Vitrified/Ceramic matt finish tiles in floors of well-known brands.
Exclusively designed 600 mm X 300 mm Ceramic wall tiles dado up to door height of well-known brands.

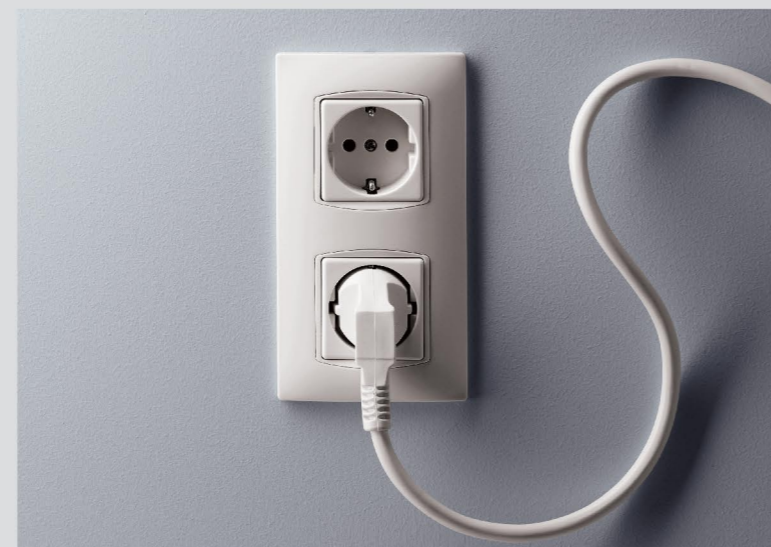

WATER SUPPLY

Dedicated mechanized bore well for continuous & healthy water supply.

KITCHEN

Granite cooking platform with stainless steel sink.
C.P. fittings of reputed brands.

KITCHEN

600 mm X 600 mm Vitrified tiles in floors of well-known brands.
Exclusively designed 600 mm X 300 mm Ceramic wall Tiles dado up to two (2) feet height of well-known brands.

WINDOWS

Glazed Anodized Aluminum Windows / UPVC Windows

DOORS

Hardwood door frame with timber framed flush doors.

SECURITY FEATURES

Round the clock security.
Adequate fire detection/fighting system strictly as per fire safety norms.
CCTV Surveillance

ELECTRICALS

Concealed electrical wiring with fire resistant wires of reputed brands.
Adequate points for lights, fans & other plugs in bedrooms, toilets, kitchens with modular switches of reputed brand.
Provisions for exhaust fans in toilets & kitchens.

ELEVATOR

Three numbers of lifts, 2 passengers lift and 1 stretcher lift in each block.

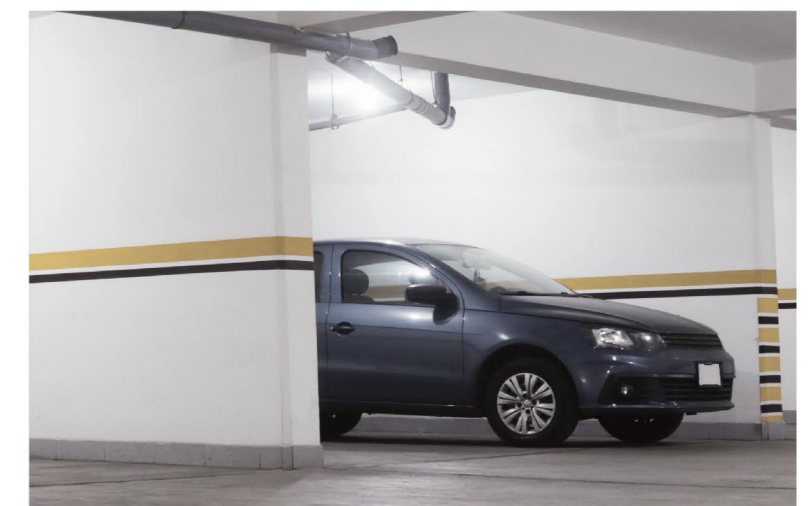
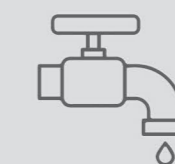

Freedom Under The Stars.

Enjoy the serene moments in this open sky terrace, ideal for lounging or enjoying peaceful, fresh air escapes.

Elevated Serenity, Open Waters.

Experience bliss at our terrace pool, surrounded by stunning views, perfect for sunbathing and unwinding under the open sky.





A Gateway to Hospitality.

Our reception lobby combines elegance and comfort, ensuring a pleasant experience for all who enter.

Your Comfort, Our Priority.

Join us for an elegant reception celebrating love and friendship, with fine dining, drinks, and unforgettable memories.



Space, Style, Sophistication Combined.

Stylish flat with minimalist decor, comfortable seating, and vibrant artwork, perfect for showcasing personality and fostering creative living.

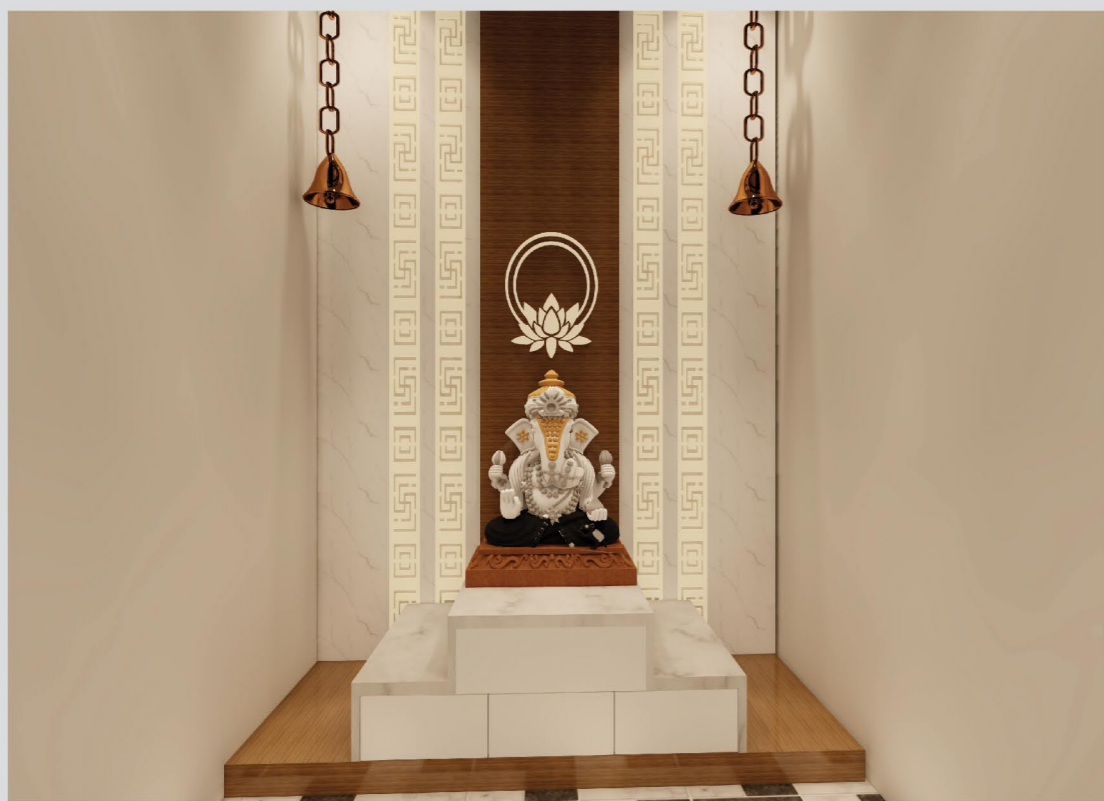

Site Plan

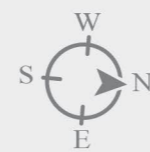

Basement Floor Plan

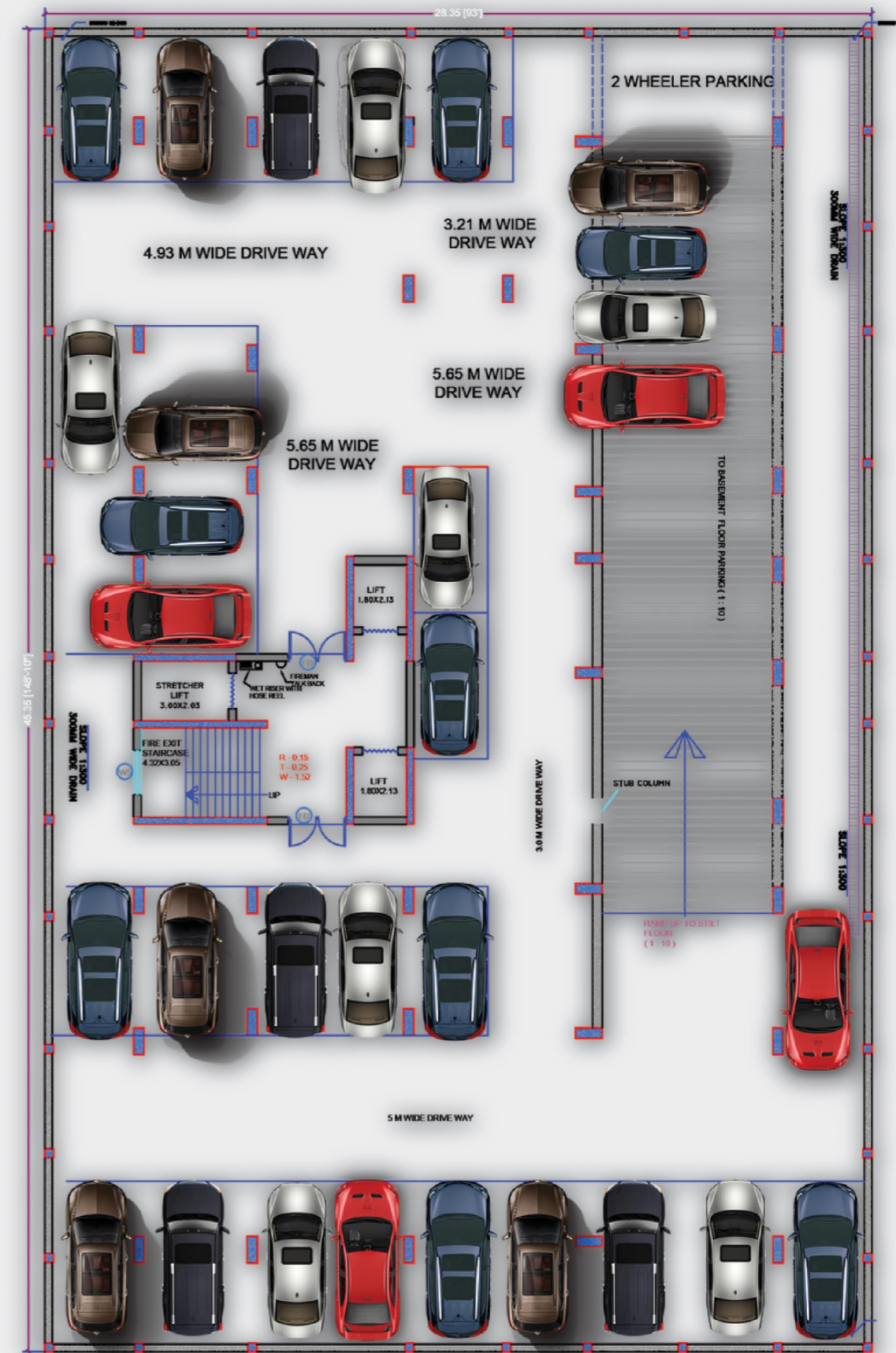

Ground Floor Plan



Upper Ground Floor Plan

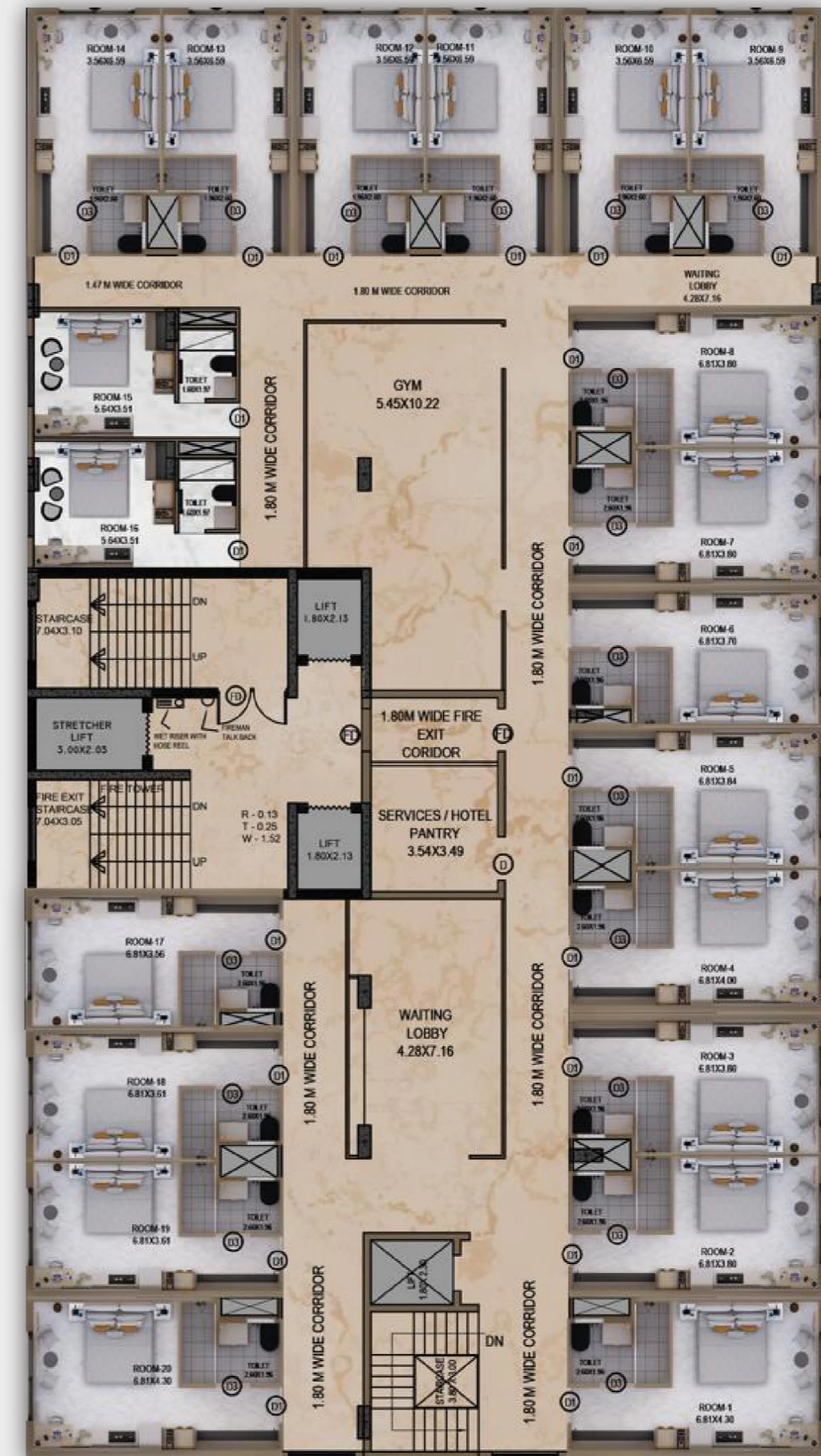

| TYPE | CARPET AREA | BUA | SBUA |
|------------|-------------|------------|-------------|
| COMMERCIAL | 7942 Sqft. | 9420 Sqft. | 16014 Sqft. |



1st To 11th Floor Plan

Unit Plan

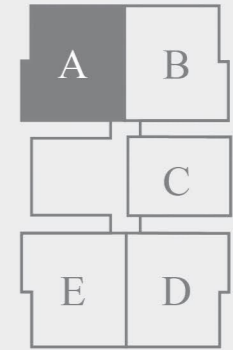

| FLAT A | TYPE | CARPET AREA | BALCONY AREA | BUA | SBUA |
|---|---------|----------------|---------------|----------------|----------------|
| 101, 201, 301, 401, 501, 601, 701, 801, 901, 1001, 1101 | 3.5 BHK | 1405.021 Sqft. | 316.340 Sqft. | 1721.361 Sqft. | 2452.939 Sqft. |

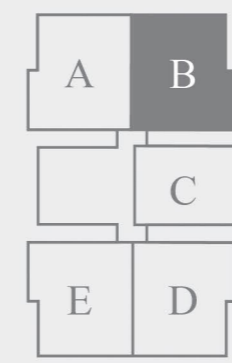

| FLAT B | TYPE | CARPET AREA | BALCONY AREA | BUA | SBUA |
|---|-------|----------------|---------------|----------------|----------------|
| 102, 202, 302, 402, 502, 602, 702, 802, 902, 1002, 1102 | 3 BHK | 1368.895 Sqft. | 352.471 Sqft. | 1721.366 Sqft. | 2448.643 Sqft. |



Unit Plan

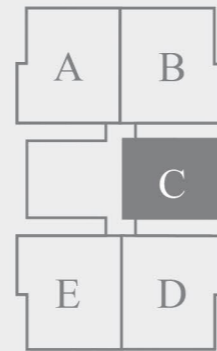

| FLAT C | TYPE | CARPET AREA | BALCONY AREA | BUA | SBUA |
|---|-------|---------------|---------------|----------------|----------------|
| 103, 203, 303, 403, 503, 603, 703, 803, 903, 1003, 1103 | 3 BHK | 987.706 Sqft. | 204.022 Sqft. | 1191.728 Sqft. | 1695.233 Sqft. |

Unit Plan

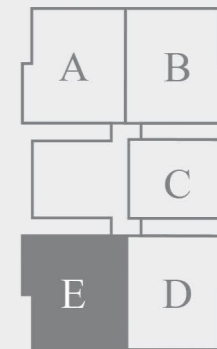
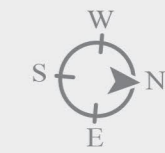

| FLAT E | TYPE | CARPET AREA | BALCONY AREA | BUA | SBUA |
|---|---------|----------------|---------------|----------------|----------------|
| 105, 205, 305, 405, 505, 605, 705, 805, 905, 1005, 1105 | 3.5 BHK | 1405.021 Sqft. | 316.340 Sqft. | 1721.361 Sqft. | 2452.939 Sqft. |

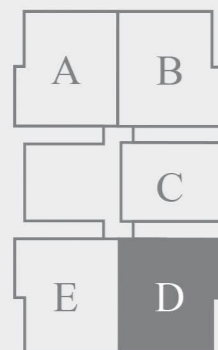

| FLAT D | TYPE | CARPET AREA | BALCONY AREA | BUA | SBUA |
|---|-------|----------------|---------------|----------------|----------------|
| 104, 204, 304, 404, 504, 604, 704, 804, 904, 1004, 1104 | 3 BHK | 1368.895 Sqft. | 352.471 Sqft. | 1721.366 Sqft. | 2452.947 Sqft. |



FLAT A
3.5 BHK
2452.939 Sqft.

Isometric View

Isometric View



FLAT B
3 BHK
2448.643 Sqft.

Isometric View



FLAT D
3 BHK
2452.947 Sqft.

FLAT C
3 BHK
1695.233 Sqft.



FLAT E
3.5 BHK
2452.939 Sqft.



Terrace Floor Plan



Legends

- 1. Swimming Pool
- 2. Roof Top
- 3. Amenities
- 4. Gymnasium
- 5. Cafeteria
- 6. Lift
- 7. Lobby
- 8. Staircase

BUSINESS CENTRE



KEY DISTANCE

| | | | | | |
|--|---------|-------|---|---------|--------|
| Petals Public School | 500 Mtr | 2 Min | DN Regalia Mall | 4.3 Km | 9 Min |
| Saint Arnolds School | 1.8 Km | 4 Min | All India Institute of Medical Sciences | 6.4 Km | 12 Min |
| DAV Public School | 2.0 Km | 5 Min | Baramunda Bus Stand | 5.2 Km | 13 Min |
| Apeejay School | 2.1 Km | 5 Min | Birla Global University | 5.8 Km | 13 Min |
| IGKC Multispecialty Hospital | 2.1 Km | 4 Min | NMIET | 5.8 Km | 15 Min |
| AMRI Hospital | 3.1 Km | 8 Min | C. V. Raman Global University | 6.4 Km | 15 Min |
| Odisha University of Technology and Research | 3.8 Km | 8 Min | Biju Patnaik International Airport | 10.2 Km | 21 Min |
| SUM Hospital | 4.1 Km | 9 Min | Bhubaneswar Railway Station | 12.2 Km | 25 Min |

Elevate Your Life, Sky-High Living.

From the sky, behold our stunning landscape - a harmonious blend of architecture and nature. Our aerial view showcases the pinnacle of luxury living, where beauty meets sophistication.

