



BLOCK A

RADHAKUNJA APARTMENT

An address to the Refinement of your Lifestyle.

LOCATION MAP

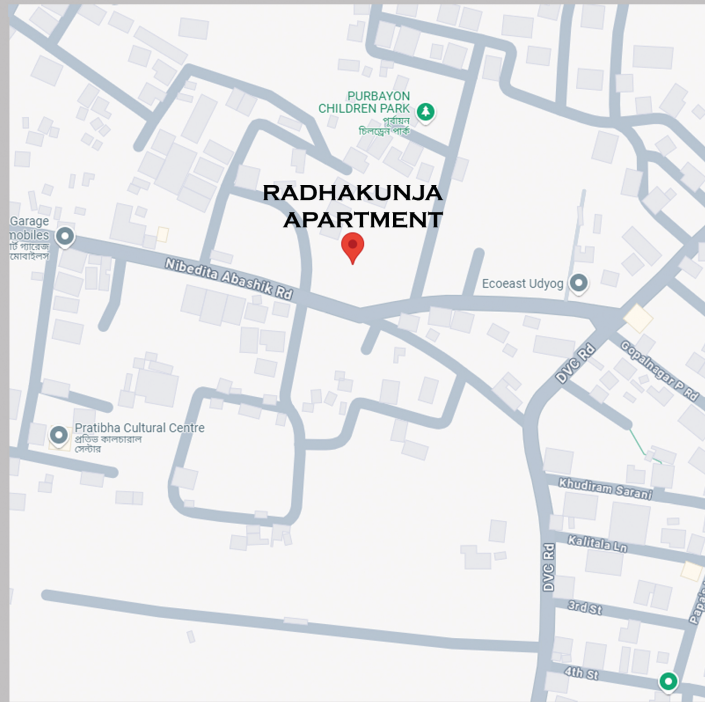

SITE ADDRESS

**RADHAKUNJA APARTMENT
KANAINATSHAL, NEAR
SARBAMILAN SANGHA CLUB, BARDHAMAN**

LOCATION ADVANTAGE

- ST XAVIER'S SCHOOL DISTANCE 500 MTRS
- SWAMI VIVEKANAND SCHOOL 500 MTRS,
- NURSING HOME LESS THAN 1KM
- ALISHA BUS STAND LESS THAN 1KM
- PETROL PUMP LESS THAN 1KM
- BAZAR LESS THAN 1KM
- NATIONAL HIGHWAY LESS THAN 500 MTRS
- GT ROAD LESS THAN 500 MTRS

**WB RERA APPROVED
WBRERA/P/PUR/2025/002820
A PROJECT OF :**



JOY MAAKAMAKHYA CONSTRUCTION PRIVATE LIMITED

+91 8101434001 / +91 8250012567



BLOCK B

FULLY MARBLE FINISHED FLOORING

BRANDED SANITARY AND ELECTRICAL FITTINGS

AUTOMATIC ELIVATOR

24*7 SECURITY GUARD & CCTV

POWER BACKUP BY DG

EARTHQUAKE RESISTANT STRUCTURE

ENOUGH PARKING SPACE

ROOF TOP GARDEN

PROJECT APPROVED BY SBI & UCO BANK

ENOUGH OPEN SPACE

SITE MAP

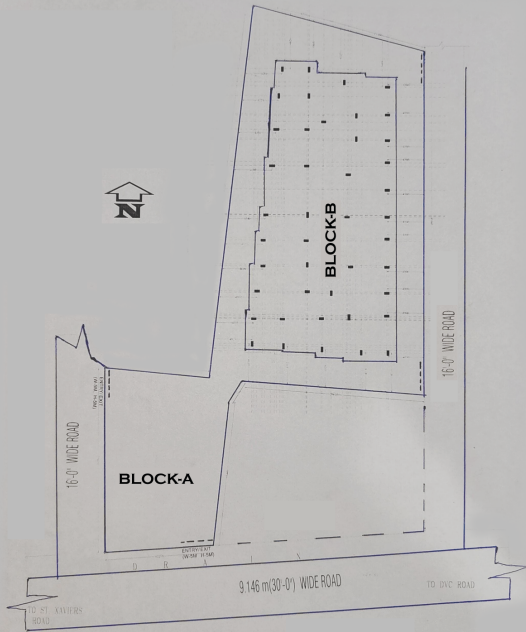

BLOCK A

TYPICAL FLOOR PLAN



BLOCK B

TYPICAL FLOOR PLAN



BLOCK A

FLAT BUILT UP SALEABLE AREA

A	852 SQ.FT	1108 SQ.FT
B	493 SQ.FT	641 SQ.FT
C	537 SQ.FT	698 SQ.FT

BLOCK B

FLAT BUILT UP SALEABLE AREA

A	759 SQ.FT	987 SQ.FT
B	799 SQ.FT	1039 SQ.FT
C	672 SQ.FT	874 SQ.FT
D	658 SQ.FT	855 SQ.FT
E	628 SQ.FT	816 SQ.FT
F	691 SQ.FT	898 SQ.FT