



**SHAKTHI**  
FOUNDATIONS  
*Futuristic constructor*

 **Brindhavan**

 **SHAKTHI**  
FOUNDATIONS  
*Futuristic constructor*

 **Brindhavan**

**Site Address**

**Plot No. 14/11, Jothy Nagar 3rd Street**

**Chitlapakkam**

**Chennai - 600064**

**(Near Varadharaja Theatre)**

# Ground Floor Plan

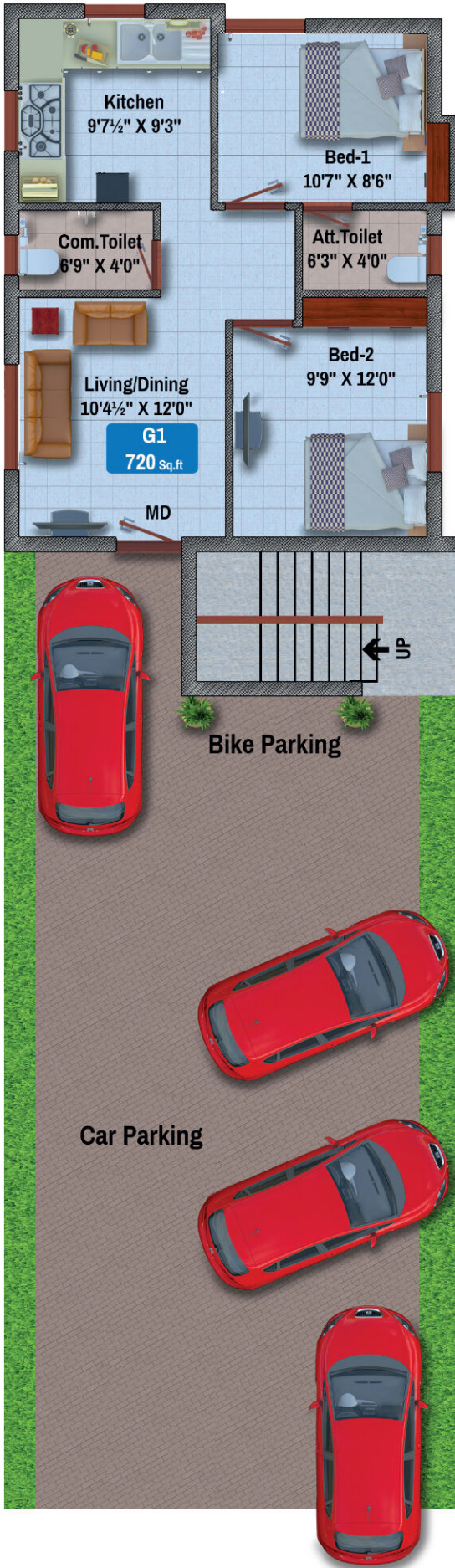

# First Floor Plan

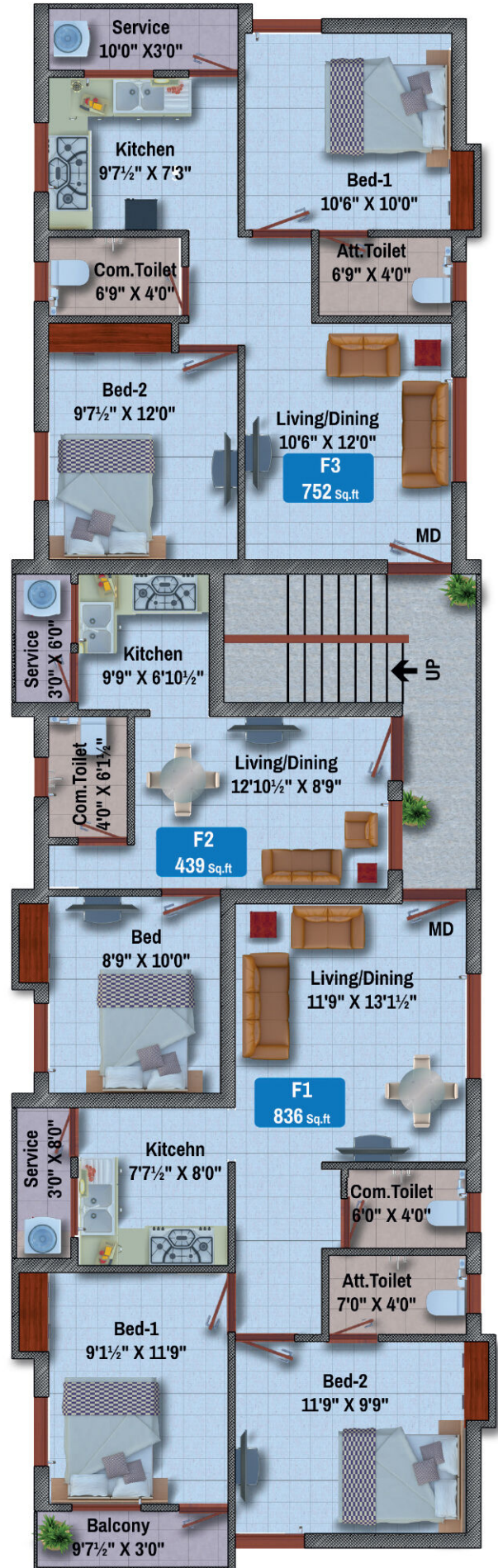

# Second Floor Plan



## Area Details



FLAT NAME	PLINTH AREA (SFT)	COMMON AREA (SFT)	SALEABLE AREA (SFT)	UDS (SFT)
Ground Floor				
G1	600	120	720	358
First Floor				
F1	697	139	836	415
F2	366	73	439	218
F3	627	125	752	374
Second Floor				
S1	697	139	836	415
S2	369	74	443	220
<b>TOTAL</b>	<b>3356</b>	<b>684</b>	<b>4026</b>	<b>2000</b>

## Schedule of Payments

- ◆ Down payment at the time of Booking: 5%
- ◆ Before Registration of Land: 45%
- ◆ On Completion of Respective Roof Slab: 10% each Roof completion
- ◆ Upon Completion of Brick work and Internal Plastering: 5% + 5%
- ◆ Laying of Tile Flooring: 5%
- ◆ Before Handing Over: 5%

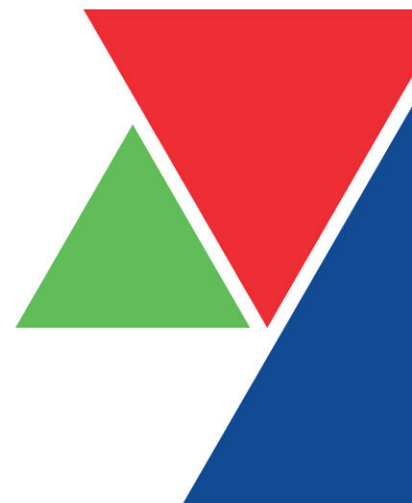
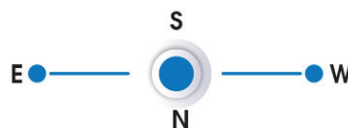

## SPECIFICATIONS

### Structure

R.C.C Framed Structure with columns, beam and Slab

### Walls

Red Blocks panel wall plastered with cement mortar

### Flooring

Flooring with quality vitrified tiles 2'X 2' size with 4" skirting

### Main Door

First quality teak wood frame and door with Varnish finish

### Inner Door

Flush Doors

### Window

Steel grill and UPUV Framed with glassed shutter

### Toilets

Ceramic wall tiles design upto 7 feet height. Concealed water line with shower, Cold and Hot water taps. Electrical provision for Geyser. Indian or European closet and ceramic tiles flooring with PVC doors.

### Sanitary Ware

Taps, Showers, Wash basins & Toilets with branded ones such as Hindware, Parryware, Jaguar etc..

### Electrical

3 Phase electrical supply with concealed ISI cable wiring for all sufficient points. AC point provision for all Bedrooms with Inverter provision

### Painting

Double wall putty with long lasting smooth finish of branded premium emulsion paint, long lasting branded luxury exterior finish.

### Kitchen

Black Granite cooling platform with Stainless steel sink. Ceramic wall tiles design upto 2 feet from platform. One open cupboard & RCC Loft will be provided

### Others

Sump, Overhead tank, bore wells will be provided

## KEYPLAN

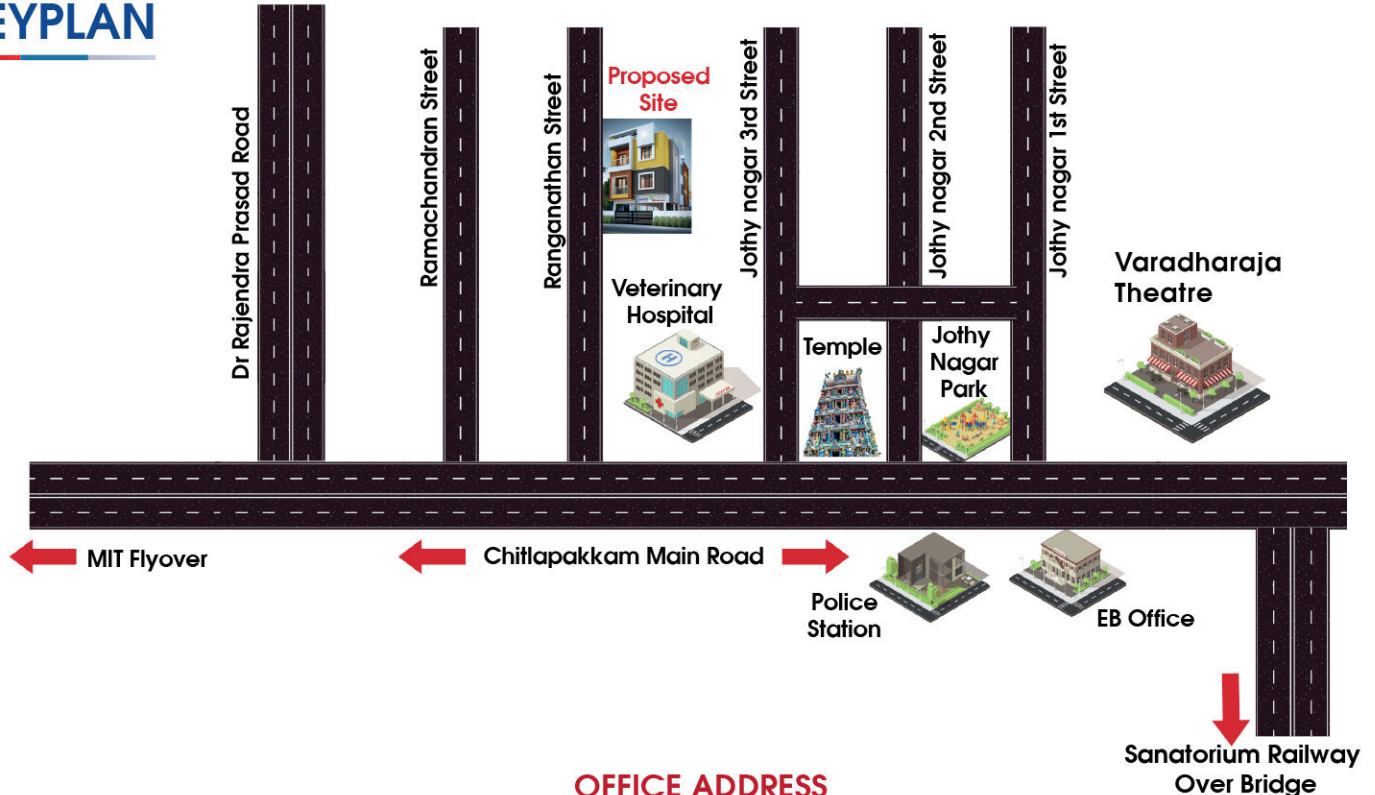

### OFFICE ADDRESS

1/229, GST Road, Tambaram sanatorium, Chennai - 600047

**M : 8838170008 / 94440 83143**

shakthifoundations.om@gmail.com