

OF ALL  
THE WORLDS  
THE FIRST  
UNFOLDS

ON NH 44,  
NORTH BENGALURU



ONCE, THE CITY THAT  
PULLED YOU APART.  
NOW DRAWS YOU CLOSER.

PATHWAYS JOIN,  
CIRCLES CLOSE,  
A PATTERN TAKES PLACE.

THIS IS WHERE THE  
CITY LEARNS TO LIVE AS  
**ONeworld**



Representative image

## ALL THE *Worlds* LIVE AS ONE

GROWTH IS EASY. COHERENCE IS RARE.

Most cities chase the first and forget the second.



Cities grow. People scatter. Life stretches far. We move further for work, wait longer for leisure, stretch ourselves between fragments and call it living.

But growth without coherence is only noise. What if living could be arranged differently? Not as parts, but as a whole.

That is the idea of **Century OneWorld**.

A first-of-its-kind integrated township in North Bengaluru where distance disappears. Where work folds into leisure, learning flows into culture, and every hour of the day home-runs, as complete.

The orbit of living circles back to a single centre. This is what life needed all along. Not just growth. But a wholesome balance.

And that's why OneWorld rises in the North not at the ends of the city, but at the centre of now.

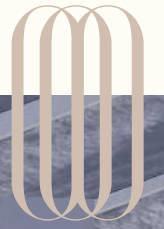

  
**THE SERAYA**  
AT CENTURY ONEWORLD  
CURATED PLOTS

APARTMENTS

EDUCATION

COMMERCIAL

# ALL OF *everything*, ALL TOGETHER.

SCATTERED CITY LIFE UNITE IN A SEAMLESS SYNC

Born of a vision, to reimagine how we belong in a city. It changes the idea of home from an address into an ecosystem, where all that we chase, growth, joy, friendship, peace, finds a shared horizon.

Conceptual drawings, designs, and areas are indicative only and liable to change without prior notice.



noun  
*/seraya/*

THE FIRST  
CHAPTER OF THE  
ONEWORLD  
*Saga*



*Bali* WITHIN.  
BLISS ALL  
AROUND.

---

Like every vision must find a place to begin with.  
For Century OneWorld, that beginning is The Seraya.  
It reveals itself gradually.

Like a breeze, every minute in The Seraya is fragrant,  
unhurried, as though time itself has loosened its grip.

A 55-acre plotted Balinese paradise that doesn't  
rush life forward, instead unfolds it step by step,  
breath by breath.

Broad, tree-lined avenues glide, frangipani blossoms  
perfume the air, with 4 lush parks open like daybreaks.

Light filters through bamboo groves,  
drifting softly across the cobbled pathways,  
a rhythm where time itself slows.

The charm of Bali lives here in the ease of life,  
ingrained in every inch of land.

*A state of calm you can call yours,  
forever.*



FROM HERE TO  
EVERYWHERE,  
*Center* OF  
ALL CIRCLES.

- ▲ Century Projects
- 🎓 Education
- 🛒 Shopping
- 🏢 Tech Parks
- 🏥 Healthcare
- 🍷 Hospitality
- 🌳 Recreation
- 🚇 Metro Line

Above mentioned timings are subject to traffic fluctuations  
MAP NOT TO SCALE



# Calm IS THE PLAN, MASTERED BY BLISS.

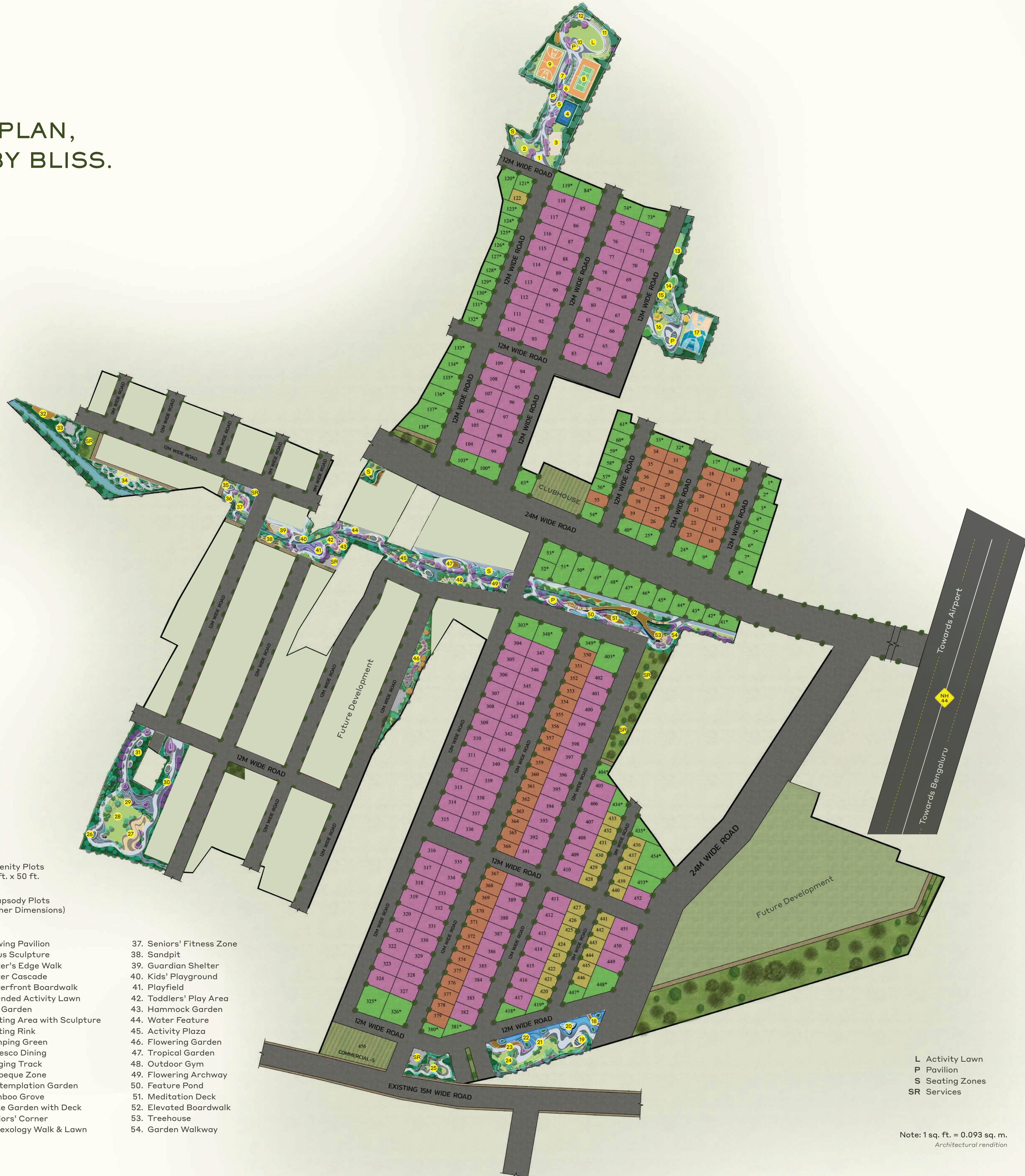

## LEGENDS

- Tranquility Plots  
30 ft. x 40 ft.
- Ecstasy Plots  
40 ft. x 60 ft.
- Serenity Plots  
30 ft. x 50 ft.
- Rhapsody Plots  
(Other Dimensions)

- 1. Entry Plaza
- 2. Pet / Paws' Garden
- 3. Sand Volleyball
- 4. Pickleball Court
- 5. Water Feature
- 6. Garden Walk
- 7. Bleacher Seats
- 8. Tennis Court
- 9. Basketball Court
- 10. Performance Platform
- 11. Amphitheatre
- 12. Climbing Wall
- 13. Cricket Practice Pitch
- 14. Golf Putting Greens
- 15. Sand Area
- 16. Sports Lawn
- 17. Multipurpose Court
- 18. Bridge
- 19. Viewing Pavilion
- 20. Lotus Sculpture
- 21. Water's Edge Walk
- 22. Water Cascade
- 23. Waterfront Boardwalk
- 24. Mounded Activity Lawn
- 25. Zen Garden
- 26. Seating Area with Sculpture
- 27. Skating Rink
- 28. Camping Green
- 29. Alfresco Dining
- 30. Jogging Track
- 31. Barbeque Zone
- 32. Contemplation Garden
- 33. Bamboo Grove
- 34. Maze Garden with Deck
- 35. Seniors' Corner
- 36. Reflexology Walk & Lawn
- 37. Seniors' Fitness Zone
- 38. Sandpit
- 39. Guardian Shelter
- 40. Kids' Playground
- 41. Playfield
- 42. Toddlers' Play Area
- 43. Hammock Garden
- 44. Water Feature
- 45. Activity Plaza
- 46. Flowering Garden
- 47. Tropical Garden
- 48. Outdoor Gym
- 49. Flowering Archway
- 50. Feature Pond
- 51. Meditation Deck
- 52. Elevated Boardwalk
- 53. Treehouse
- 54. Garden Walkway

- L Activity Lawn
- P Pavilion
- S Seating Zones
- SR Services

Note: 1 sq. ft. = 0.093 sq. m.  
Architectural rendition



# *Belong* TO THE BALINESE DREAM

---

SOMEWHERE BETWEEN DREAM AND  
DWELLING, WONDER LIVES.

From landscapes shaped by Land Design One, Singapore  
to 60+ thoughtful amenities, every detail is tuned  
to rhythm, rest, and respite.

Life comes dressed in wonder.

Mornings, afternoons, and evenings all linger  
a little longer to lose time, and find oneself again.



Representative image

*Morning* WALKS IN,  
ON DEWY FEET.  
THE TREES SING  
SOFTLY OF BEGINNINGS.



Elevated  
Boardwalk



Flowering  
Archway



Golf Putting  
Greens



Concept Illustration

THE HOURS REST  
IN *green* SHADE.  
TIME DRIFTS LIKE  
A RIVER ON RACE.



Hammock  
Garden



Skating  
Rink



Pets'  
Garden



Concept Illustration



Representative image



Representative image

THE FIREFLIES GATHER VOICES OF *dusk*.  
LIGHT LINGERS, UNWILLING TO LEAVE.



Amphitheatre



Multipurpose  
Court



Zen  
Garden



Concept Illustration

THE MOON SHIMMERS  
ON STILL WATERS.

*Laughter* RISES LIKE  
STARS IN BLOOM.



Alfresco  
Dining



Camping  
Green



Barbeque  
Zone



Concept Illustration



Representative image

IN THE *Seraya*,  
TIME DOES NOT SQUANDER  
FAR AND WIDE.  
IT RETURNS WHOLE  
TO THOSE WHO LIVE HERE.



# THE SERAYA IS NOT THE *finale*.

IT IS A PRELUDE.

The first note of a symphony,  
that will only rise, district by district,  
into a township alive with culture, commerce,  
and celebration.

Addresses transforming into landmarks,  
neighbourhoods evolving into communities.

And it begins at a moment charged  
with momentum.

To stand here is to feel the city turning its axis,  
to know that the future is not approaching it  
has already arrived.

What Seraya begins, OneWorld will magnify  
not just keeping pace with change, but setting  
the stage for what comes next...



Representative image

*OneWorld.*  
*For all your worlds.*  
*And this is just the beginning...*

*A legacy* OF 5 DECADES -  
HARNESSING THE PAST,  
DEFINING THE PRESENT, AND  
CREATING THE BLUEPRINT FOR THE FUTURE.



3,000+ ACRES  
OF LAND BANK



25+ MN. SQ. FT.  
OF QUALITY ASSETS



30+ PRESTIGIOUS  
AWARDS



**DISCLAIMER:**

The information and material contained or referred to in this document are for reference only. Century Real Estate Holdings Pvt. Ltd. makes no representation or warranty of any kind expressed, implied or statutory regarding this report or the materials and information contained or referred to on each page associated with this report. The information and materials contained in this report are subject to change without notice, are provided for general information only and should not be used as a basis for making business decisions. Any information or advice received via this document should not be relied upon without consulting primary or more accurate or more up-to-date sources of information or specific professional advice. All images in this document are for representational purposes only.

**CENTURY REAL ESTATE HOLDINGS PVT. LTD.**

Century HQ, Opp. Jakkur Aerodrome  
Airport Road, Bengaluru 560 065, India.

| [www.centuryrealestate.in](http://www.centuryrealestate.in)

RERA. Reg. No. PRM/KA/RERA/1251/309/PR/050725/007894

