

Chanchal

Chanchal Infrastructure Pvt. Ltd.

Saransh ambience

2 & 3 BHK High-End Lifestyle Apartments & Shops



We are in the business of building... Trust!

Forty year ago, the foundation stone of the Chanchal group was laid with a passion to create the best homes for the middle-income segment a passion that has today become our deep-rooted building philosophy. It's this spirit of celebrating life for a family, irrespective of its income, that is reflected in each of our works.

We are a third-generation construction major foraying into newer grounds of sophisticated living with high-end and life style apartments, and industrial and logistic Parks.

In continuation, we bring to you the answer to every middle-class family's daydream of living in style. We bring you the end of that search for an affordable, yet high-end living with new level of lifestyle experience, at your price.

We bring you Saransh Ambience. Because, we build trust.



Saransh
ambience

VOGUE

FASHION CLOTHES

FASHION CLOTHES

FASHION CLOTHES

FASHION CLOTHES

FASHION CLOTHES

FASHION CLOTHES

FASHION CLOTHES

FASHION CLOTHES

FASHION CLOTHES

FASHION CLOTHES

FASHION CLOTHES

FASHION CLOTHES

FASHION CLOTHES

FASHION CLOTHES

FASHION CLOTHES

FASHION CLOTHES

FASHION CLOTHES

FASHION CLOTHES

FASHION CLOTHES

FASHION CLOTHES

VOGUE

VOGUE

VOGUE

VOGUE

VOGUE

VOGUE

VOGUE

VOGUE

VOGUE

MOBILE

MOBILE

MOBILE

MOBILE

MOBILE

MOBILE

MOBILE

MOBILE



Block - A & C

3 BHK



Block - A, C, E & F

2 BHK

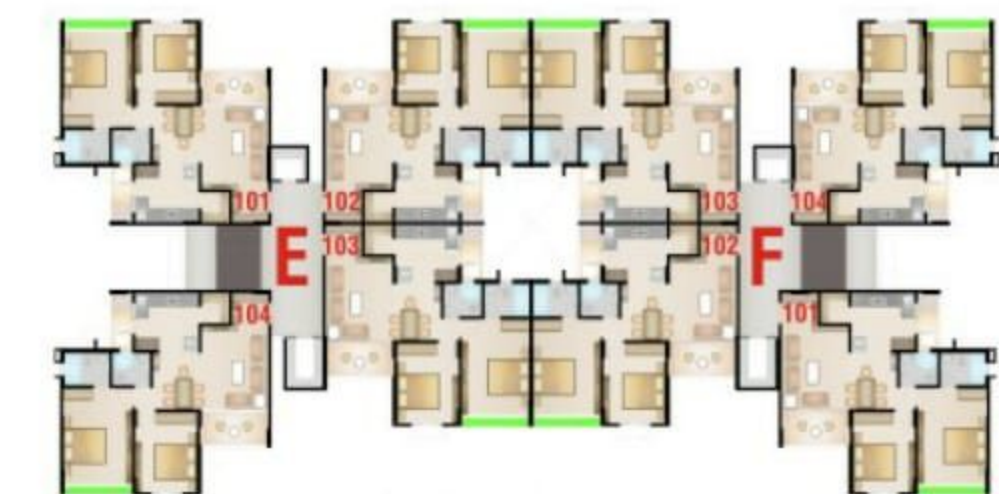
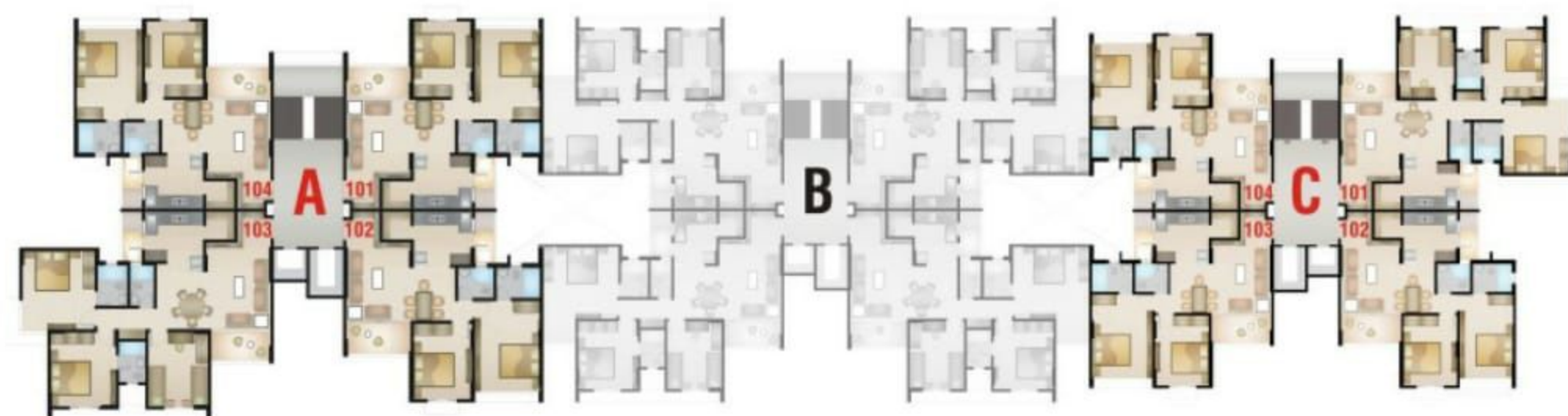



Block - B

3 BHK

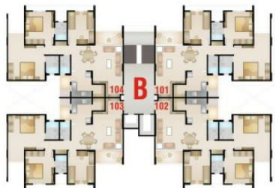



Block - D

3 BHK



Block - D

3 BHK



Specification



Foyer
Entrance foyer with courtyard and security system.



Structure
Earthquake resistant, RCC Framed structure with infill brick walls.



Flooring

- Living dining, hallway and foyar 2' x2' Vitrified tiles.
- Master bed room – Wooden flooring / 2'x2' vitrified tiles.
- Kitchen – Vitrified Tiles • Toilet : Designer Ceramic Tiles.



Kitchen
Granite Platform with S.S. Sink, Coloured glazed tiles upto lintal level.



Doors & Windows
Decorative entrance Door, Wooden Doors in other rooms, fully UPVC windows.



Wall Finish:
Internal Smooth finish mala Plaster with wall putty external walls with 100% Acrylic paint.



Electrification
Concealed copper wiring with modular switches & accessories telephone, AC Point & T.V. Point in Bedroom.



Toilet
Premium quality C.P. Fittings, Good quality of sanitary Ware.

Feature

- Centrally located and surrounded by low-rise residential development
- High quality construction and finishes
- Practically designed eco-friendly features
- Surrounded with full grown trees
- Landscaped garden
- Safe play area for children
- Multi apartment Security system
- Central Satellite dish
- 2 elevators
- Allotted parking spaces per unit in basement and ground level
- Designated waiting area for staff
- 24 hours security & water supply
- Backup Generator for Lift and water Pumps.



Chanchal

Architect
Saransh

Structure Engineer:
Setu Infrastructure

Site Add:
Saransh Ambience

Nr. Dr. Jivraj Mehta Hospital, Dharnidhar, Vasna Ahmedabad-380 007.

For Booking Contact Number : 97220 00018